

NOTICE!!

These documents have been scanned!

Do not place un-scanned documents beneath this notice!

Do not remove this notice from this file!

GPO Jacket No. 560-102
Print Order 61540
Rise Business Services, LLC
Job=AZ15 5/14/2019



Box Number= AZ15049



Claim Begin-End: AMC414585-AMC414590

1 Initial Receipt



AZ15049-14

AMC414434-AMC414683

United States Department of the Interior
Bureau of Land Management
 LANDS/RECREATION & PLANNING
 ONE N CENTRAL AVE
 PHOENIX, AZ 85004 -2203
 Phone: 602-417-9200

Receipt

No:

2541414

Transaction #: 2620030

Date of Transaction: 03/30/2012

ENTERED INTO COMPUTER

CUSTOMER:

APR 04 2012

PB

DENNIS E NOLEN
 HC 70 BOX 4610
 SAHUARITA, AZ 85629-9318 US

*\$174 refund authorized for
 maint. & location fees paid on
 AMC 414588 & 1c mining claim
 was null & void do not*

RS 10-15-12

LINE #	QTY	DESCRIPTION	REMARKS	UNIT PRICE	TOTAL
1	6.00	LOCATABLE MINERALS / MINING CLAIMS- NEW, UNADJUD, ONE OR MORE AUTH NOS / NEW MINING CLAIM LOCATION FEE \$34 CASES: AMC414585/\$34.00, AMC414586/\$34.00, AMC414587/\$34.00, AMC414588/\$34.00, AMC414589/ \$34.00, AMC414590/\$34.00		- n/a -	204.00
2	6.00	LOCATABLE MINERALS / MINING CLAIMS- NEW, UNADJUD, ONE OR MORE AUTH NOS / NEW MINING CLAIM MAINT FEE \$140 CASES: AMC414585/\$140.00, AMC414586/\$140.00, AMC414587/\$140.00, AMC414588/\$140.00, AMC414589/ \$140.00, AMC414590/\$140.00		- n/a -	840.00
3	6.00	LOCATABLE MINERALS / MINING CLAIMS- NEW, UNADJUD, ONE OR MORE AUTH NOS / NEW MINING CLAIM PROCESSING FEE \$15 CASES: AMC414585/\$15.00, AMC414586/\$15.00, AMC414587/\$15.00, AMC414588/\$15.00, AMC414589/ \$15.00, AMC414590/\$15.00		- n/a -	90.00
TOTAL:					\$1,134.00

PAYMENT INFORMATION

1	AMOUNT:	1134.00	POSTMARKED:	03/29/2012
	TYPE:	CHECK	RECEIVED:	03/30/2012
	CHECK NO:	231		
	NAME:	NOLEN, TERRY J HC 70 BOX 4610 SAHUARITA AZ 85629-9318 US		

REMARKS

This receipt was generated by the automated BLM Collections and Billing System and is a paper representation of a portion of the official electronic record contained therein.

NOTICE!!

These documents have been scanned!

Do not place un-scanned documents beneath this notice!

Do not remove this notice from this file!

GPO Jacket No. 560-102
Print Order 61540
Rise Business Services, LLC
Job=AZ15 5/14/2019



Box Number= AZ15049



Claim Begin-End: AMC414585-AMC414590

2 Correspondence



AZ15049-14

AMC414434-AMC414683

August 24, 2012

Enclosed is a request for refund
in regards to withdrawing an intent
to relocate a mining claim.

Maintenance Fees in a total
of 66 claims and a check
for 140^{00} per claim $\times 66 = \$9240^{00}$

Any questions please contact me
at

Dennis Nolen
HC 70 Box 4610
Sahuarita AZ 85629

520-625-0980

RECEIVED
BLM AZ STATE OFFICE
2012 AUG 28 P 1:18
PHOENIX, ARIZONA

August 24, 2012

Bureau of Land Management
One N. Central Ave.
Phoenix, AZ 85004-4427

RE: 3800(9310) RE
AMC414585

In regards to the decision made on the mining claim AMC414588, New Leadville #11, see attached papers, I am requesting a refund of maintenance and location fees for this claim. I am withdrawing my intent to relocate this claim.

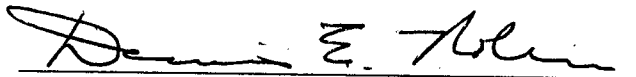

Dennis E. Nolen

Please send the fees to:

Dennis E. Nolen
HC 70 Box 4610
Sahuarita, AZ 85629
520-625-0980

RECEIVED
BLM AZ STATE OFFICE
2012 AUG 28 P 1:18
PHOENIX, ARIZONA



United States Department of the Interior

BUREAU OF LAND MANAGEMENT

Arizona State Office

One North Central Avenue, Suite 800

Phoenix, Arizona 85004-4427

www.blm.gov/az/

July 3, 2012



In Reply Refer To:
3800 (9310) RE
AMC414585

RECEIVED
BLM AZ STATE OFFICE
2012 AUG 28 P 1:18
PHOENIX, ARIZONA

CERTIFIED MAIL - RETURN RECEIPT REQUESTED No. 7011 3500 0000 8349 2816

- DECISION -

Dennis Nolen	:	This Decision Affects Those Claims
HC70, Box 4610	:	Shown in the Block Below.
Sahuarita, AZ 85629-9318	:	

AMC414588
New Leadville #11

Mining Claim(s) Declared Null and Void Ab Initio

Pursuant to Title 43 Code of Federal Regulations (CFR) 3832.1, this office received your notice(s) of location for recording mining claims. In accordance with 43 CFR 3833.91, the claim(s) listed above is/are hereby declared null and void ab initio for the reason indicated below. A copy of the Master Title Plat is enclosed for your convenience, if applicable.

The claim is located on land that was patented under the Stock Raising Homestead Act of December 29, 1916(43 U.S.C. 299). Prior to locating mining claims on these lands you must comply with Public Law 103-23; 107 Stat. 60, effective October 13, 1993, and the 43 CFR Part 3838.

This decision does not relieve you of the liability for reclamation of all areas disturbed by your activities on land encompassed by your mining claim(s) and/or site(s). After you complete the reclamation, you must notify the authorized officer of the appropriate surface managing agency so that the authorized officer may conduct a final site inspection and determine whether you may be released from liability. If you fail to reclaim the land to the satisfaction of the authorized officer, the surface management agency may cite you for noncompliance under its surface management regulations.

For land administered by the BLM, if you fail to reclaim the land to the satisfaction of the authorized officer as required in 43 CFR Subpart 3809, the BLM will issue an order of noncompliance under 43 CFR 3809.601(a). If you fail to comply with the noncompliance order, the BLM may take further action under 43 CFR 3809.604. Failure to conduct reclamation is a prohibited act that may subject you to criminal penalties. See 43 CFR 3809.605(h) and 43 CFR 3809.700. If your occupancy has been terminated and you fail to remove structures, material, and equipment, and any personal property in accordance with the regulations in 43 CFR 3715.5-1, the BLM may dispose of the property. In accordance with 43 CFR 3715.5-2, you will remain liable for the costs the BLM incurs in removing and disposing of the property.

This decision may be appealed to the Interior Board of Land Appeals, Office of the Secretary, in accordance with the regulations contained in 43 CFR, Part 4 and the enclosed Form 1842-1. If an appeal is taken, your notice of appeal must be filed in this office (at the above address) within 30 days from receipt of this decision. The appellant has the burden of showing that the decision appealed from is in error.

If you wish to file a petition pursuant to regulation 43 CFR 4.21 (58 FR 4939, January 19, 1993), for a stay of the effectiveness of this decision during the time that your appeal is being reviewed by the Board, the petition for a stay must accompany your notice of appeal. A petition for a stay is required to show sufficient justification based on the standards listed below. Copies of the notice of appeal and petition for a stay must also be submitted to each party named in this decision and to the Interior Board of Land Appeals and to the appropriate Office of the Solicitor (see 43 CFR 4.413) at the same time the original documents are filed with this office. If you request a stay, you have the burden of proof to demonstrate that a stay should be granted.

Standards for Obtaining a Stay

Except as otherwise provided by law or other pertinent regulation, a petition for a stay of a decision pending appeal shall show sufficient justification based on the following standards:

- (1) The relative harm to the parties if the stay is granted or denied,
- (2) The likelihood of the appellant's success on the merits,
- (3) The likelihood of immediate and irreparable harm if the stay is not granted, and
- (4) Whether the public interest favors granting the stay.

RECEIVED
BLM AZ STATE OFFICE
2012 AUG 28 P 1:18
PHOENIX, ARIZONA

If additional information is required, please contact Rod Ebert at 602-417-9397. Please include your AMC serial number(s) on all correspondence.

Rebecca Heick

Rebecca Heick
Group Administrator
Lands and Minerals

RECEIVED
BLM AZ STATE OFFICE
2012 AUG 28 P 1:18
PHOENIX, ARIZONA

July 3, 2012

3833 (9310) RE
AMC414585

CERTIFIED MAIL - RETURN RECEIPT REQUESTED No. 7011 3500 0000 8349 2816

NOTICE

Dennis Nolen	:	This Notice Affects the Claims
HC70, Box 4610	:	Shown in the Block Below.
Sahuarita, AZ 85629-9318	:	

AMC414585 - AMC414587 AMC414589 - AMC414590
Golden Fleece #5, Golden Fleece #6, New Leadville #10, Sycamore #3, White Bluff #3

No Rights Acquired on Portions of Lode Claim(s)

Pursuant to Title 43 Code of Federal Regulations 3832.1, this office received your notice(s) of location for recordation of mining claims.

However, portions of the lode mining claim(s) listed above appear to lie within lands that are not open to location for the following reason:

The claims are partially located on land that was patented under the Stock Raising Homestead Act of December 29, 1916(43 U.S.C. 299). Prior to locating mining claims on these lands you must comply with Public Law 103-23; 107 Stat. 60, effective October 13, 1993, and the 43 CFR Part 3838.

Therefore, although the claim(s) has/have been recorded, you have acquired no rights on any portion of the subject mining claim(s) that lie within these lands. Enclosed for reference is a copy of the Master Title Plat.

If additional information is required, please contact Rod Ebert at 602-417-9397. Please include your AMC serial number(s) on all correspondence.

/s/ Rebecca Heick

Rebecca Heick
Group Administrator
Lands and Minerals

Enclosures

REbert:lm:070312

OFFICIAL COPIES: /Case Files/ /SD Read/ /Section/ /Author

July 3, 2012

In Reply Refer To:
3800 (9310) RE
AMC414585

CERTIFIED MAIL - RETURN RECEIPT REQUESTED No. 7011 3500 0000 8349 2816

DECISION

Dennis Nolen	:	This Decision Affects Those Claims
HC70, Box 4610	:	Shown in the Block Below.
Sahuarita, AZ 85629-9318	:	

AMC414588
New Leadville #11

Mining Claim(s) Declared Null and Void Ab Initio

Pursuant to Title 43 Code of Federal Regulations (CFR) 3832.1, this office received your notice(s) of location for recording mining claims. In accordance with 43 CFR 3833.91, the claim(s) listed above is/are hereby declared null and void ab initio for the reason indicated below. A copy of the Master Title Plat is enclosed for your convenience, if applicable.

The claim is located on land that was patented under the Stock Raising Homestead Act of December 29, 1916(43 U.S.C. 299). Prior to locating mining claims on these lands you must comply with Public Law 103-23; 107 Stat. 60, effective October 13, 1993, and the 43 CFR Part 3838.

This decision does not relieve you of the liability for reclamation of all areas disturbed by your activities on land encompassed by your mining claim(s) and/or site(s). After you complete the reclamation, you must notify the authorized officer of the appropriate surface managing agency so that the authorized officer may conduct a final site inspection and determine whether you may be released from liability. If you fail to reclaim the land to the satisfaction of the authorized officer, the surface management agency may cite you for noncompliance under its surface management regulations.

SENDER: COMPLETE THIS SECTION

- Complete items 1, 2, and 3. Also complete item 4 if Restricted Delivery is desired.
- Print your name and address on the reverse so that we can return the card to you.
- Attach this card to the back of the mailpiece, or on the front if space permits.

1. Article Addressed to:

Dennis Nolen
HC70, Box 4610
Sahuarita, AZ 85629-9318
9310 RE AMC414585

2. Article Number

(Transfer from service label)

7011 3500 0000 8349 2816

COMPLETE THIS SECTION ON DELIVERY

A. Signature

X

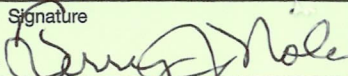

☐ Agent

☒ Addressee

B. Received by (Printed Name)

C. Date of Delivery

D. Is delivery address different from item 1? ☐ Yes
If YES, enter delivery address below: ☐ No

3. Service Type

☐ Certified Mail

☐ Express Mail

☐ Registered

☐ Return Receipt for Merchandise

☐ Insured Mail

☐ C.O.D.

4. Restricted Delivery? (Extra Fee)

☐ Yes

UNITED STATES POSTAL SERVICE



First-Class Mail
Postage & Fees Paid
USPS
Permit No. G-10

- Sender: Please print your name, address, and ZIP+4 in this box •

RECEIVED
BLM AZ STATE OFFICE

2012 JUL -9 PM 1:24

PHOENIX, ARIZONA

BUREAU OF LAND MANAGEMENT
ARIZONA STATE OFFICE
ONE NORTH CENTRAL AVENUE
SUITE 800
PHOENIX, AZ 85004-2203



For land administered by the BLM, if you fail to reclaim the land to the satisfaction of the authorized officer as required in 43 CFR Subpart 3809, the BLM will issue an order of noncompliance under 43 CFR 3809.601(a). If you fail to comply with the noncompliance order, the BLM may take further action under 43 CFR 3809.604. Failure to conduct reclamation is a prohibited act that may subject you to criminal penalties. See 43 CFR 3809.605(h) and 43 CFR 3809.700. If your occupancy has been terminated and you fail to remove structures, material, and equipment, and any personal property in accordance with the regulations in 43 CFR 3715.5-1, the BLM may dispose of the property. In accordance with 43 CFR 3715.5-2, you will remain liable for the costs the BLM incurs in removing and disposing of the property.

This decision may be appealed to the Interior Board of Land Appeals, Office of the Secretary, in accordance with the regulations contained in 43 CFR, Part 4 and the enclosed Form 1842-1. If an appeal is taken, your notice of appeal must be filed in this office (at the above address) within 30 days from receipt of this decision. The appellant has the burden of showing that the decision appealed from is in error.

If you wish to file a petition pursuant to regulation 43 CFR 4.21 (58 FR 4939, January 19, 1993), for a stay of the effectiveness of this decision during the time that your appeal is being reviewed by the Board, the petition for a stay must accompany your notice of appeal. A petition for a stay is required to show sufficient justification based on the standards listed below. Copies of the notice of appeal and petition for a stay must also be submitted to each party named in this decision and to the Interior Board of Land Appeals and to the appropriate Office of the Solicitor (see 43 CFR 4.413) at the same time the original documents are filed with this office. If you request a stay, you have the burden of proof to demonstrate that a stay should be granted.

Standards for Obtaining a Stay

Except as otherwise provided by law or other pertinent regulation, a petition for a stay of a decision pending appeal shall show sufficient justification based on the following standards:

- (1) The relative harm to the parties if the stay is granted or denied,
- (2) The likelihood of the appellant's success on the merits,
- (3) The likelihood of immediate and irreparable harm if the stay is not granted, and
- (4) Whether the public interest favors granting the stay.

If additional information is required, please contact Rod Ebert at 602-417-9397. Please include your AMC serial number(s) on all correspondence.

/s/ Rebecca Heick

Rebecca Heick
Group Administrator
Lands and Minerals

Enclosures
REbert:lm:070312

[English](#)[Customer Service](#)[USPS Mobile](#)[Register / Sign In](#)[Search USPS.com or Track Packages](#)[Quick Tools](#)[Ship a Package](#)[Send Mail](#)[Manage Your Mail](#)[Shop](#)[Business Solutions](#)

Track & Confirm

[GET EMAIL UPDATES](#) [PRINT DETAILS](#)**YOUR LABEL NUMBER**

7011350000083492816

SERVICE**STATUS OF YOUR ITEM****DATE & TIME****LOCATION****FEATURES**

Delivered

July 17, 2012, 12:04 pm

SAHUARITA, AZ 85629

Certified Mail™

Arrival at Unit

July 05, 2012, 9:56 am

SAHUARITA, AZ 85629

Check on Another Item

What's your label (or receipt) number?

Find**LEGAL**[Privacy Policy »](#)[Terms of Use »](#)[FOIA »](#)[No FEAR Act EEO Data »](#)**ON USPS.COM**[Government Services »](#)[Buy Stamps & Shop »](#)[Print a Label with Postage »](#)[Customer Service »](#)[Site Index »](#)**ON ABOUT.USPS.COM**[About USPS Home »](#)[Newsroom »](#)[Mail Service Updates »](#)[Forms & Publications »](#)[Careers »](#)**OTHER USPS SITES**[Business Customer Gateway »](#)[Postal Inspectors »](#)[Inspector General »](#)[Postal Explorer »](#)

Copyright© 2012 USPS. All Rights Reserved.

NOTICE!!

These documents have been scanned!

Do not place un-scanned documents beneath this notice!

Do not remove this notice from this file!

GPO Jacket No. 560-102
Print Order 61540
Rise Business Services, LLC
Job=AZ15 5/14/2019



Box Number= AZ15049



Claim Begin-End: AMC414585-AMC414590

3 Transfers



AZ15049-14

AMC414434-AMC414683

**NO
DOCUMENTS
FOUND**

NO DOCUMENTS FOUND
NO DOCUMENTS FOUND

NOTICE!!

These documents have been scanned!

Do not place un-scanned documents beneath this notice!

Do not remove this notice from this file!

GPO Jacket No. 560-102
Print Order 61540
Rise Business Services, LLC
Job=AZ15 5/14/2019



Box Number= AZ15049



Claim Begin-End: AMC414585-AMC414590

4 Miscellaneous



AZ15049-14

AMC414434-AMC414683

**NO
DOCUMENTS
FOUND**

NO DOCUMENTS FOUND
NO DOCUMENTS FOUND

NOTICE!!

These documents have been scanned!

Do not place un-scanned documents beneath this notice!

Do not remove this notice from this file!

GPO Jacket No. 560-102
Print Order 61540
Rise Business Services, LLC
Job=AZ15 5/14/2019



Box Number= AZ15049



Claim Begin-End: AMC414585-AMC414590

5 Annual Filings



AZ15049-14

AMC414434-AMC414683

41485

After recording, please return to:
 Dennis E. Nolen
 HC 70 Box 4610
 Sahuarita, AZ 85629

RECEIVED
 BLM AZ STATE OFFICE
 2019 AUG 13 A 8:06
 PHOENIX, ARIZONA

STATE OF ARIZONA)
)ss:
 County of Pima)

**CERTIFICATON OF PAYMENT OF MAINTENANCE FEE IN LIEU OF
 AFFIDAVIT OF ANNUAL ASSESSMENT WORK**

Dennis E. Nolen, being first duly sworn, deposes and says that:

1. He is one of the owners of the following described unpatented lode mining claims situated in the Sierrita Mountains, Pima County, Arizona (the "Claims"), the location notices of which are of record in said county, and in the records of the Arizona State Office of the Bureau of Land Management under the file numbers indicated as follows:

SERIAL NUMBER	NAME OF CLAIM	CLAIMANT'S NAME
AMC 414585	Golden Fleece #5	Dennis E. Nolen Patrick J Nolen
AMC 414586	Golden Fleece #6	" " "
AMC 414587	New Leadville #10	" " "
AMC 414589	Sycamore #3	" " "
AMC 414590	White Bluff #3	" " "

The Claims are situated in Section 10, Township 18 South, Range 11 East, G&SR Meridian.

2. Pursuant to the Sections 10101 (a) and (b) of the Omnibus Budget Reconciliation Act of 1993 (Act of August 10, 1993, 107 Stat. 312), as extended by the Department of the Interior and Related Agencies Appropriations Act of October 21, 1998 (P.L. 105-277) and 43 CFR § 3833.1-5(b), the owner has paid a maintenance fee of \$165.00 per claim for the assessment year beginning September 1, 20 , and this Certificate is in lieu of an affidavit of performance of annual assessment work or notice of intent of hold.

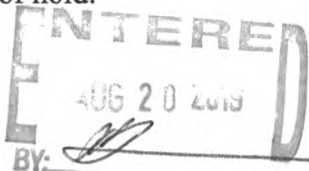

4532212

3. The names and address of the owners of Claims for which this Certificate is prepared are: Dennis E. Nolen and Patrick J. Nolen, HC 70 Box 4610, Sahuarita, AZ 85629.

THIS IS NOT A CHANGE OF ADDRESS

4. The Claims are held and claimed by the owners for the valuable mineral contained therein.

DATED this 23 day of July, 2017

Dennis E. Nolen
Dennis E. Nolen

The foregoing instrument was acknowledged before me this 23 day of July, 2017, by Dennis E. Nolen.

Pily Dumbolton
Notary Public

My Commission Expires:

08-24-2020

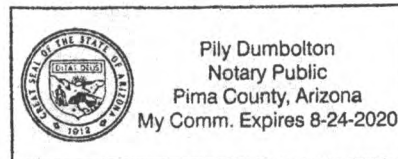

RECEIVED
BLM AZ STATE OFFICE
2019 AUG 13 A 8:06
PHOENIX, ARIZONA

United States Department of the Interior
Bureau of Land Management
DIV OF LANDS, MINRLS & ENERGY
ONE N CENTRAL AVE
PHOENIX, AZ 85004 -4427
Phone: 602-417-9200

Receipt	
No:	4532212

Transaction #: 4653079**Date of Transaction:** 08/14/2019**CUSTOMER:**

DENNIS E NOLEN
HC 70 BOX 4610
SAHUARITA, AZ 85629-9318 US

LINE #	QTY	DESCRIPTION	REMARKS	UNIT PRICE	TOTAL
1	1.00	LOCATABLE MINERALS / MINING CLAIMS- NOT NEW-UNADJUD, ONE AUTH NO. ONLY / MINING CLAIM MONEY RECEIVED CASES: AMC414585/\$825.00	MAINT 2020/5	- n/a -	825.00
TOTAL:					\$825.00

PAYMENT INFORMATION				
1	AMOUNT:	825.00	POSTMARKED:	N/A
	TYPE:	CHECK	RECEIVED:	08/13/2019
	CHECK NO:	809		
	NAME:	NOLEN, TERRY J HC 70 BOX 4610 SAHUARITA AZ 85629-9318 US		

REMARKS

This receipt was generated by the automated BLM Collections and Billing System and is a paper representation of a portion of the official electronic record contained therein.

41485

After recording, please return to:
 Dennis E. Nolen
 HC 70 Box 4610
 Sahuarita, AZ 85629

RECEIVED
 BLM AZ STATE OFFICE
 2019 AUG 13 A 8:06
 PHOENIX, ARIZONA

STATE OF ARIZONA)
)ss:
 County of Pima)

**CERTIFICATON OF PAYMENT OF MAINTENANCE FEE IN LIEU OF
 AFFIDAVIT OF ANNUAL ASSESSMENT WORK**

Dennis E. Nolen, being first duly sworn, deposes and says that:

1. He is one of the owners of the following described unpatented lode mining claims situated in the Sierrita Mountains, Pima County, Arizona (the "Claims"), the location notices of which are of record in said county, and in the records of the Arizona State Office of the Bureau of Land Management under the file numbers indicated as follows:

SERIAL NUMBER	NAME OF CLAIM	CLAIMANT'S NAME
AMC 414585	Golden Fleece #5	Dennis E. Nolen
		Patrick J Nolen
AMC 414586	Golden Fleece #6	" " "
AMC 414587	New Leadville #10	" " "
AMC 414589	Sycamore #3	" " "
AMC 414590	White Bluff #3	" " "

The Claims are situated in Section 10, Township 18 South, Range 11 East, G&SR Meridian.

2. Pursuant to the Sections 10101 (a) and (b) of the Omnibus Budget Reconciliation Act of 1993 (Act of August 10, 1993, 107 Stat. 312), as extended by the Department of the Interior and Related Agencies Appropriations Act of October 21, 1998 (P.L. 105-277) and 43 CFR § 3833.1-5(b), the owner has paid a maintenance fee of \$165.00 per claim for the assessment year beginning September 1, 20 , and this Certificate is in lieu of an affidavit of performance of annual assessment work or notice of intent of hold.

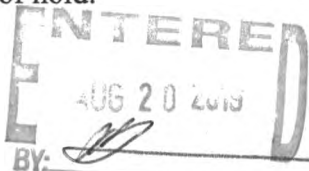

4532212

3. The names and address of the owners of Claims for which this Certificate is prepared are: Dennis E. Nolen and Patrick J. Nolen, HC 70 Box 4610, Sahuarita, AZ 85629.

THIS IS NOT A CHANGE OF ADDRESS

4. The Claims are held and claimed by the owners for the valuable mineral contained therein.

DATED this 23 day of July, 2017

Dennis E. Nolen
Dennis E. Nolen

The foregoing instrument was acknowledged before me this 23 day of July, 2017, by Dennis E. Nolen.

Pily Dumbolton
Notary Public

My Commission Expires:

08-24-2020

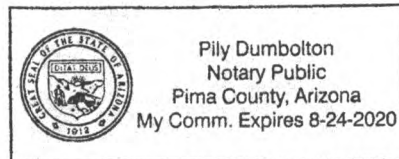

RECEIVED
BLM AZ STATE OFFICE
2019 AUG 13 A 8:06
PHOENIX, ARIZONA

United States Department of the Interior
Bureau of Land Management
DIV OF LANDS, MINRLS & ENERGY
ONE N CENTRAL AVE
PHOENIX, AZ 85004 -4427
Phone: 602-417-9200

Receipt	
No:	4532212

Transaction #: 4653079**Date of Transaction:** 08/14/2019**CUSTOMER:**

DENNIS E NOLEN
HC 70 BOX 4610
SAHUARITA, AZ 85629-9318 US

LINE #	QTY	DESCRIPTION	REMARKS	UNIT PRICE	TOTAL
1	1.00	LOCATABLE MINERALS / MINING CLAIMS- NOT NEW-UNADJUD, ONE AUTH NO. ONLY / MINING CLAIM MONEY RECEIVED CASES: AMC414585/\$825.00	MAINT 2020/5	- n/a -	825.00
TOTAL:					\$825.00

PAYMENT INFORMATION				
1	AMOUNT:	825.00	POSTMARKED:	N/A
	TYPE:	CHECK	RECEIVED:	08/13/2019
	CHECK NO:	809		
	NAME:	NOLEN, TERRY J HC 70 BOX 4610 SAHUARITA AZ 85629-9318 US		

REMARKS

This receipt was generated by the automated BLM Collections and Billing System and is a paper representation of a portion of the official electronic record contained therein.

August 26, 2018

AMC 414585

BLM

AMC 332724

Enclosed are mining claims
annual assessments:

RECEIVED
BLM AZ STATE OFFICE
2018 AUG 28 P 1:31
PHOENIX, ARIZONA

Dennis Nolen with Patrick Nolen
5 claims #775⁰⁰

Nolen McGee Medema
36 claims zeks 1860 3720 7⁹¹ 5580⁰⁰

Please return stamped copies to

Dennis Nolen
HC70 Box 4610
Sahuarita AZ
85629

520-625-0980

dennynolen@msn.com

ENTERED
SEP 04 2018
BY: RAN

#425009

After recording, please return to:
Dennis E. Nolen
HC 70 Box 4610
Sahuarita, AZ 85629

RECEIVED
BLM AT STATE OFFICE
2018 AUG 28 P 1:31
PHOENIX, ARIZONA

STATE OF ARIZONA)
)ss:
County of Pima)

**CERTIFICATON OF PAYMENT OF MAINTENANCE FEE IN LIEU OF
AFFIDAVIT OF ANNUAL ASSESSMENT WORK**

Dennis E. Nolen, being first duly sworn, deposes and says that:

1. He is one of the owners of the following described unpatented lode mining claims situated in the Sierrita Mountains, Pima County, Arizona (the "Claims"), the location notices of which are of record in said county, and in the records of the Arizona State Office of the Bureau of Land Management under the file numbers indicated as follows:

SERIAL NUMBER	NAME OF CLAIM	CLAIMANT'S NAME
AMC 414585	Golden Fleece #5	Dennis E. Nolen
AMC 414586	Golden Fleece #6	Patrick J Nolen
AMC 414587	New Leadville #10	" " "
AMC 414589	Sycamore #3	" " "
AMC 414590	White Bluff #3	" " "

The Claims are situated in Section 10, Township 18 South, Range 11 East, G&SR Meridian.

2. Pursuant to the Sections 10101 (a) and (b) of the Omnibus Budget Reconciliation Act of 1993 (Act of August 10, 1993, 107 Stat. 312), as extended by the Department of the Interior and Related Agencies Appropriations Act of October 21, 1998 (P.L. 105-277) and 43 CFR § 3833.1-5(b), the owner has paid a maintenance fee of \$155.00 per claim for the assessment year beginning September 1, 2018 and this Certificate is in lieu of an affidavit of performance of annual assessment work or notice of intent of hold.

3. The names and address of the owners of Claims for which this Certificate is prepared are: Dennis E. Nolen and Patrick J. Nolen, HC 70 Box 4610, Sahuarita, AZ 85629.

THIS IS NOT A CHANGE OF ADDRESS

4. The Claims are held and claimed by the owners for the valuable mineral contained therein.

DATED this 27 day of August, 2018

Dennis E. Nolen Pres/CEO
Dennis E. Nolen

The foregoing instrument was acknowledged before me this 27 day of

August, 2018, by Dennis E. Nolen.

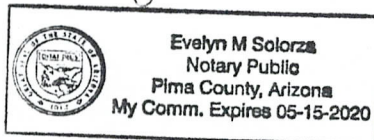

Evelyn M. Solorza
Notary Public

My Commission Expires:

05/15/2020

RECEIVED
BLM AZ STATE OFFICE
2018 AUG 28 P 1:32
PHOENIX, ARIZONA

After recording, please return to:
Dennis E. Nolen
HC 70 Box 4610
Sahuarita, AZ 85629

RECEIVED
PIMA STATE OFFICE
2018 AUG 28 P 1:32
PHOENIX, ARIZONA

STATE OF ARIZONA)
)ss:
County of Pima)

CERTIFICATION OF PAYMENT OF MAINTENANCE FEE IN LIEU OF AFFIDAVIT OF ANNUAL ASSESSMENT WORK

Dennis E. Nolen, being first duly sworn, deposes and says that:

1. He is one of the owners of the following described unpatented lode mining claims situated in the Sierrita Mountains, Pima County, Arizona (the "Claims"), the location notices of which are of record in said county, and in the records of the Arizona State Office of the Bureau of Land Management under the file numbers indicated as follows:

See three attached Case Claim sheet

The Claims are situated in Sections 1, 2, 4, 9, 10, 11, 14, 15, and 35, Townships 17 South, and 18 South, Range 11 East, G&SR Meridian.

2. Pursuant to the Sections 10101 (a) and (b) of the Omnibus Budget Reconciliation Act of 1993 (Act of August 10, 1993, 107 Stat. 312), as extended by the Department of the Interior and Related Agencies Appropriations Act of October 21, 1998 (P.L. 105-277) and 43 CFR § 3833.1-5(b), the owner has paid a maintenance fee of \$155 per claim for the assessment year beginning September 1, 2018 and this Certificate is in lieu of an affidavit of performance of annual assessment work or notice of intent of hold.

3. The names and address of the owners of Claims for which this Certificate is prepared are:
Dennis E. Nolen, Louis L. McGee, C.E. Medema, HC 70 Box 4610, Sahuarita, AZ 85629.

THIS IS NOT A CHANGE OF ADDRESS

4. The Claims are held and claimed by the owners for the valuable mineral contained therein.

DATED this 27 day of August, 2018

Dennis E. Nolen
Dennis E. Nolen

The foregoing instrument was acknowledged before me this 27 day of August, 2018, by Dennis E. Nolen.

Evelyn M Solorza
Notary Public

My Commission Expires:

05-15-2020

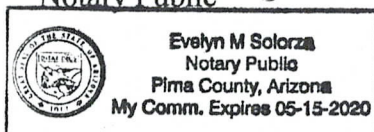

<u>SERIAL NUMBER</u>	<u>CLAIM NAME</u>	<u>CLAIMANT'S NAME</u>
A MC 332736	Leadville #5	Dennis E. Nolen Louis L. McGee C.E. Medema
A MC 332737	Leadville #6	" " "
A MC 332738	New Leadville #9	" " "
A MC 332739	Leadville #14	" " "
A MC 332740	May Bird #26	" " "
A MC 332741	New East Star Extension #8	" " "
A MC 332742	New East Star Extension # 9	" " "
A MC 332743	New East Star Extension #10	" " "
A MC 332744	New East Star Extension #11	" " "
A MC 332745	New East Star Extension #12	" " "
A MC 332746	New East Star Extension #13	" " "
A MC 332747	New East Star Extension #14	" " "

PHOENIX, ARIZONA

2018 AUG 28 P 1:32

RECEIVED
BLM AZ STATE OFFICE

<u>SERIAL NUMBER</u>	<u>CLAIM NAME</u>	<u>CLAIMANT'S NAME</u>
A MC 332748	New East Star #15	Dennis E. Nolen Louis L. McGee C.E. Medema
A MC 332749	New East Star #16	" " " " " " " " "
A MC 332750	New East Star Extension #17	" " " " " " " " "
A MC 332751	New East Star Extension #19	" " " " " " " " "
A MC 332752	New East Star Extension #20	" " " " " " " " "
A MC 332753	New East Star Extension #21	" " " " " " " " "
A MC 332754	New East Star Extension #22	" " " " " " " " "
A MC 332755	New East Star Extension #25	" " " " " " " " "
A MC 332756	Red Eagle #1	" " " " " " " " "
A MC 332757	Red Eagle #4	" " " " " " " " "
A MC 332758	Red Eagle #10	" " " " " " " " "
A MC 332759	Red Eagle #11	" " " " " " " " "

PHOENIX, ARIZONA

2018 AUG 28 P 1:32

RECEIVED
BLM AZ STATE OFFICE

CASE CLAIM

<u>SERIAL NUMBER</u>	<u>CLAIM NAME</u>	<u>CLAIMANT'S NAME</u>
A MC 332724	Eagle #12	Dennis E. Nolen Louis L. McGee C.E. Medema
A MC 332725	Keystone # 1	" " "
A MC 332726	Keystone #2	" " "
A MC 332727	Keystone #3	" " "
A MC 332728	Keystone #4	" " "
A MC 332729	Keystone #5	" " "
A MC 332730	Keystone #10	" " "
A MC 332731	Keystone #11	" " "
A MC 332732	Keystone #12	" " "
A MC 332733	Keystone #13	" " "
A MC 332734	Keystone #14	" " "
A MC 332735	Leadville #4	" " "

2010 AUG 28 P 1:32

RECEIVED
BLM AZ STATE OFFICE

PHOENIX, ARIZONA

United States Department of the Interior
Bureau of Land Management
 DIV OF LANDS, MINRLS & ENERGY
 ONE N CENTRAL AVE
 PHOENIX, AZ 85004 -4427
 Phone: 602-417-9200

Receipt

No: 4250009

Transaction #: 4365497	
Date of Transaction: 08/30/2018	
CUSTOMER:	
DENNIS E NOLEN HC 70 BOX 4610 SAHUARITA, AZ 85629-9318 US	

LINE #	QTY	DESCRIPTION	REMARKS	UNIT PRICE	TOTAL
1	1.00	LOCATABLE MINERALS / MINING CLAIMS- NOT NEW-UNADJUD, ONE AUTH NO. ONLY / MINING CLAIM MONEY RECEIVED CASES: AMC332736/\$6355.00	MAINT 2019/41	- n/a -	6355.00
TOTAL:					\$6,355.00

PAYMENT INFORMATION				
1	AMOUNT:	3720.00	POSTMARKED:	N/A
	TYPE:	CHECK	RECEIVED:	08/28/2018
	CHECK NO:	3096		
	NAME:	GARRISON, DRENA A BOX 753 GREEN VALLEY AZ 85622 US		
2	AMOUNT:	775.00	POSTMARKED:	N/A
	TYPE:	CHECK	RECEIVED:	08/30/2018
	CHECK NO:	751		
	NAME:	NOLEN, TERRY J HC 70 BOX 4610 SAHUARITA AZ 85629 US		
3	AMOUNT:	1860.00	POSTMARKED:	N/A
	TYPE:	CHECK	RECEIVED:	08/30/2018
	CHECK NO:	770		
	NAME:	CONNIE, SHARON BOX 18792 TUCSON AZ 85731 US		

PRESS FIRMLY TO SEAL

PRESS FIRMLY TO SEAL

PRIORITY®

★ **MA PRIORITY**
★ **MAIL** ★



VISIT US AT USPS.COM
ORDER FREE SUPPLIES ONLINE



DATE OF DEL FROM:



USPS TRACKI



INSURANCE I



PICKUP AVAIL

* Domestic only

Nolen
HC 70 Box 4610
Sahuarita AZ
85629

TO:

Bureau of Land Management
Div of Land, Minrals & Energy
One N Central Ave
Phoenix AZ
85004-4427

WHEN USED INTERNAT
A CUSTOMS DECLAR
LABEL MAY BE REQ

Label 228, March 2016

FOR DOMESTIC AND INTERNATIONAL USE



PS00001000014

EP14F July 2013
OD: 12.5 x 9.5

VISIT US AT USPS.COM
ORDER FREE SUPPLIES ONLINE



Retail

P

US POSTAGE PAID
\$9.70

Origin: 85629
Destination: 85004
0 Lb 2.70 Oz
Aug 27, 18
0372890556-12

1006

PRIORITY MAIL 2-Day®

EXPECTED DELIVERY DAY: 08/29/2018

C041

USPS SIGNATURE TRACKING NUMBER



9510 8123 7573 8239 3945 26

RECEIVED
BLM AZ STATE OFFICE
2018 AUG 28 P 1:31
PHOENIX, ARIZONA



This packaging is the property of the U.S. Postal Service® and is provided solely for use in sending Priority Mail® shipments. Misuse may be a violation of federal law. This packaging is not for resale. EP14F © U.S. Postal Service; July 2013; All rights reserved.

REMARKS

This receipt was generated by the automated BLM Collections and Billing System and is a paper representation of a portion of the official electronic record contained therein.

August 26, 2016

414585

BLM

RECEIVED
BLM AZ STATE OFFICE

2016 AUG 29 A 8:44

PHOENIX, ARIZONA

Enclosed are mining claims
annual assessments

Dennis Nolen with Patrick Nolen
5 claims

\$ 775⁰⁰

Helvetia land & Cattle with Sahuarita Mining
25 claims 3 cks 1550⁵⁰
1162⁵⁰
1162⁵⁰ >

\$ 3875⁰⁰

Nolen McGee Medema
36 claims

2 cks 1860
3720 >

\$ 5580⁰⁰

Please return stamped copies to

Dennis Nolen
HC70 Box 4610

Sahuarita AZ

85629

520-625-0980

dennynolen@msn.com

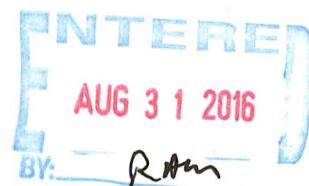

After recording, please return to:
Dennis E. Nolen
HC 70 Box 4610
Sahuarita, AZ 85629

RECEIVED
BLM AZ STATE OFFICE
2016 AUG 29 A 8:46

PHOENIX, ARIZONA

STATE OF ARIZONA)
)ss:
County of Pima)

**CERTIFICATION OF PAYMENT OF MAINTENANCE FEE IN LIEU OF
AFFIDAVIT OF ANNUAL ASSESSMENT WORK**

Dennis E. Nolen, being first duly sworn, deposes and says that:

1. He is one of the owners of the following described unpatented lode mining claims situated in the Sierrita Mountains, Pima County, Arizona (the "Claims"), the location notices of which are of record in said county, and in the records of the Arizona State Office of the Bureau of Land Management under the file numbers indicated as follows:

SERIAL NUMBER	NAME OF CLAIM	CLAIMANT'S NAME
AMC 414585	Golden Fleece #5	Dennis E. Nolen Patrick J Nolen
AMC 414586	Golden Fleece #6	" " "
AMC 414587	New Leadville #10	" " "
AMC 414589	Sycamore #3	" " "
AMC 414590	White Bluff #3	" " "

The Claims are situated in Section 10, Township 18 South, Range 11 East, G&SR Meridian.

2. Pursuant to the Sections 10101 (a) and (b) of the Omnibus Budget Reconciliation Act of 1993 (Act of August 10, 1993, 107 Stat. 312), as extended by the Department of the Interior and Related Agencies Appropriations Act of October 21, 1998 (P.L. 105-277) and 43 CFR § 3833.1-5(b), the owner has paid a maintenance fee of \$155.00 per claim for the assessment year beginning September 1, 2016, and this Certificate is in lieu of an affidavit of performance of annual assessment work or notice of intent of hold.

RECEIPT # 3647113

3. The names and address of the owners of Claims for which this Certificate is prepared are: Dennis E. Nolen and Patrick J. Nolen, HC 70 Box 4610, Sahuarita, AZ 85629.

THIS IS NOT A CHANGE OF ADDRESS

4. The Claims are held and claimed by the owners for the valuable mineral contained therein.

DATED this 26 day of August, 2016

Dennis E. Nolen
Dennis E. Nolen

The foregoing instrument was acknowledged before me this 26 day of August, 2016, by Dennis E. Nolen.

Tera L. Weech
Notary Public

My Commission Expires:

4/22/17

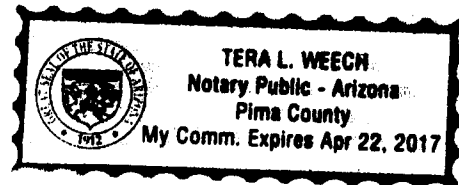

RECEIVED
BLM AZ STATE OFFICE
2016 AUG 29 A 8:46
PHOENIX, ARIZONA

Label 106A, Jan 2015



This envelope is made from post-consumer waste. Please recycle - again.

This product is for use with Priority Mail.
Misuse may be a violation of federal law.
This label is not for resale.



VISIT US AT USPS.COM®
Label 106A, Jan 2015

This product is for use with Priority Mail.
Misuse may be a violation of federal law.
This label is not for resale.



©MO:

PRIORITY MAIL

PRESS FIRMLY TO SEAL

PRIORITY MAIL

UNITED STATES POSTAL SERVICE®

VISIT US AT USPS.COM®
ORDER FREE SUPPLIES ONLINE



1021



85004

PRIORITY MAIL

U.S. POSTAGE
PAID
SAHUARITA, AZ
85629
AUG 26 16
AMOUNT
\$9.35
R2304H109228-12

PRIORITY MAIL

FROM:



DATE OF DELIVERY SI



USPS TRACKING™ INC



INSURANCE INCLUDE



PICKUP AVAILABLE

* Domestic only

Terry Nolen
HC 70 Box 4610
Sahuarita AZ 85629

TO:

BLM

One N Central Ave
Phoenix AZ
85004-2203

WHEN USED INTERNATIONALLY,
A CUSTOMS DECLARATION
LABEL MAY BE REQUIRED.

Label 228, March 2016

FOR DOMESTIC AND INTERNATIONAL USE



PS00001000014

EP14F July 2013
OD: 12.5 x 9.5

VISIT US AT USPS.COM®
ORDER FREE SUPPLIES ONLINE



United States Postal Service®
SIGNATURE CONFIRMATION™

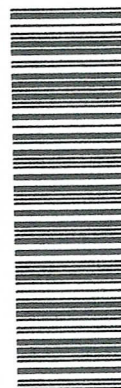

LEH9 E2H 0000 029T STE2

PHOENIX, ARIZONA

2016 AUG 29 A 8:44

RECEIVED
BLM AZ STATE OFFICE

This packaging is the property of the U.S. Postal Service® and is provided solely for use in sending Priority Mail® shipments. Misuse may be a violation of federal law. This packaging is not for resale. EP14F © U.S. Postal Service; July 2013; All rights reserved.

PRIORITY[®]

★ MAIL ★



FLAT RATE ENVELOPE
ONE RATE ★ ANY WEIGHT*



PS00001000014

EP14F July 2013
OD: 12.5 x 9.5



* Domestic only. * For international shipments, the maximum weight is 4 lbs.

United States Department of the Interior
Bureau of Land Management
DIV OF LANDS, MINRLS & ENERGY
ONE N CENTRAL AVE
PHOENIX, AZ 85004 -4427
Phone: 602-417-9200

Receipt

No:

3647113

Transaction #: 3751101	
Date of Transaction: 08/30/2016	
CUSTOMER:	
	DENNIS E NOLEN HC 70 BOX 4610 SAHUARITA, AZ 85629-9318 US

LINE #	QTY	DESCRIPTION	REMARKS	UNIT PRICE	TOTAL
1	1.00	LOCATABLE MINERALS / MINING CLAIMS- NOT NEW-UNADJUD, ONE AUTH NO. ONLY / MINING CLAIM MONEY RECEIVED CASES: AMC414585/\$775.00	MAINT FEE 2017 - 5	- n/a -	775.00
TOTAL:					\$775.00

PAYMENT INFORMATION				
1	AMOUNT:	775.00	POSTMARKED:	08/26/2016
	TYPE:	CHECK	RECEIVED:	08/29/2016
	CHECK NO:	636		
	NAME:	NOLEN, TERRY J HC 70 BOX 4610 SAHUARITA AZ 85629-9318 US		

REMARKS

This receipt was generated by the automated BLM Collections and Billing System and is a paper representation of a portion of the official electronic record contained therein.

414585

After recording, please return to:
Dennis E. Nolen
HC 70 Box 4610
Sahuarita, AZ 85629

STATE OF ARIZONA)
)ss:
County of Pima)

**CERTIFICATON OF PAYMENT OF MAINTENANCE FEE IN LIEU OF
AFFIDAVIT OF ANNUAL ASSESSMENT WORK**

Dennis E. Nolen, being first duly sworn, deposes and says that:

1. He is one of the owners of the following described unpatented lode mining claims situated in the Sierrita Mountains, Pima County, Arizona (the "Claims"), the location notices of which are of record in said county, and in the records of the Arizona State Office of the Bureau of Land Management under the file numbers indicated as follows:

SERIAL NUMBER	NAME OF CLAIM	CLAIMANT'S NAME
AMC 414585	Golden Fleece #5	Dennis E. Nolen
AMC 414586	Golden Fleece #6	Patrick J Nolen
AMC 414587	New Leadville #10	" " "
AMC 414589	Sycamore #3	" " "
AMC 414590	White Bluff #3	" " "

The Claims are situated in Section 10, Township 18 South, Range 11 East, G&SR Meridian.

2. Pursuant to the Sections 10101 (a) and (b) of the Omnibus Budget Reconciliation Act of 1993 (Act of August 10, 1993, 107 Stat. 312), as extended by the Department of the Interior and Related Agencies Appropriations Act of October 21, 1998 (P.L. 105-277) and 43 CFR § 3833.1-5(b), the owner has paid a maintenance fee of \$155.00 per claim for the assessment year beginning September 1, 2015 and this Certificate is in lieu of an affidavit of performance of annual assessment work or notice of intent of hold.

ENTERED
AUG 31 2015
BY: Ram

RECEIPT # 3379899

RECEIVED
BLM AZ STATE OFFICE
2015 AUG 27 AM 11:06

3. The names and address of the owners of Claims for which this Certificate is prepared are: Dennis E. Nolen and Patrick J. Nolen, HC 70 Box 4610, Sahuarita, AZ 85629.

THIS IS NOT A CHANGE OF ADDRESS

4. The Claims are held and claimed by the owners for the valuable mineral contained therein.

DATED this 24 day of August, 2015

Dennis E. Nolen
Dennis E. Nolen

The foregoing instrument was acknowledged before me this 24 day of August, 2015, by Dennis E. Nolen.

Tera L. Weech
Notary Public

My Commission Expires:

4/22/17

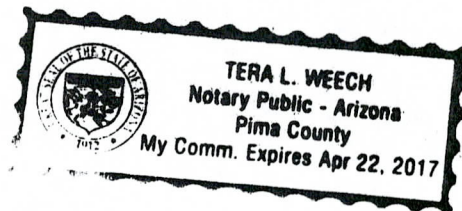

RECEIVED
BLMAZ STATE OFFICE
2015 AUG 27 A 11:06
PIMA COUNTY, ARIZONA

August 26, 2015

BLM

Enclosed are mining claims
annual assessments.

Dennis Nolen with Patrick Nolen
5 claims 1 ck \$ 775⁰⁰

Helvetia land & Cattle with Sahuarita Mining
25 claims 2 cks 2325
1550 > \$ 3875⁰⁰

Nolen McGee Medema
36 claims 3 cks 1240
2480
1860 > \$ 5580⁰⁰

Please return stamped copies to

Dennis Nolen
HC 70 Box 4610
Sahuarita AZ
85629

520-625-0980

dennynolen@msn.com

PHOENIX, ARIZONA

2015 AUG 27 A 11:06

RECEIVED
BLM AZ STATE OFFICE

RECIPIENT

The sender has requested notification upon delivery.
Immediately upon receipt, please telephone:

Name: _____
Tel. No.: _____

PLEASE PRESS FIRMLY

PLEASE PRESS FIRMLY

PLEASE PRESS FIRMLY

DuPont™ Tyvek®
Protect What's Inside.™



**EXPRESS
MAIL**

UNITED STATES POSTAL SERVICE®

WWW.

AFFIX POSTAGE OR
CORPORATE ACCOUNT



1020



95004

U.S. POSTAGE
PAID
SAHUARITA, AZ
95004
AUG 26, 15
AMOUNT
\$19.75
R2304H109228-12

EXTREMELY URGENT Please Rush To Addressee

FOR PICKUP OR TRACKING CALL 1-800-222-1811

Sig. REQ.

WRITE FIRMLY TO MAKE ALL COPIES LEGIBLE.

CUSTOMER USE ONLY

FROM: (PLEASE PRINT) PHONE (620) 625-0930

Terry Nolen
1070 Box 4610
Sahuarita AZ
85629

PAYMENT BY ACCOUNT (if applicable)

DELIVERY OPTIONS (Customer Use Only)

☒ **SIGNATURE REQUIRED** Note: The mailer must check the "Signature Required" box if the mailer: 1) Requires the addressee's signature; OR 2) Purchases additional insurance; OR 3) Purchases COD service; OR 4) Purchases Return Receipt service. If the box is not checked, the Postal Service will leave the item in the addressee's mail receptacle or other secure location without attempting to obtain the addressee's signature on delivery.

Delivery Options

☐ No Saturday Delivery (delivered next business day)

☐ Sunday/Holiday Delivery Required (additional fee, where available)

☐ 10:30 AM Delivery Required (additional fee, where available)

*Refer to USPS.com or local Post Office for availability.

TO: (PLEASE PRINT) PHONE ()

BLM
One N Central Ave
Phoenix AZ

ZIP + 4® (U.S. ADDRESSES ONLY) 85004-2203

■ For pickup or USPS Tracking™, visit USPS.com or call 800-222-1811.
■ \$100.00 insurance included.



EK230677689US



UNITED STATES
POSTAL SERVICE®

**PRIORITY
★ MAIL ★
EXPRESS™**

ORIGIN (POSTAL SERVICE USE ONLY)

☐ 1-Day ☐ 2-Day ☐ Military ☐ DPO

PO ZIP Code 856029 Scheduled Delivery Date (MM/DD/YYYY) 8/28/15

Date Accepted (MM/DD/YYYY) 8/26/15

Time Accepted ☐ AM ☐ PM 10:48

Weight 0.320 lbs

☐ Flat Rate ☐ Sunday/Holiday Premium Fee

Postage \$16.95

Insurance Fee \$

Return Receipt Fee \$

Live Animal Transportation Fee \$

Job Postage & Fees \$16.95

Acceptance Employee Initials

DELIVERY (POSTAL SERVICE USE ONLY)

Delivery Attempt (MM/DD/YYYY) Time Employee Signature

☐ AM ☐ PM

Delivery Attempt (MM/DD/YYYY) Time Employee Signature

☐ AM ☐ PM

LABEL T1-B, JANUARY 2014 PSN 7590-02-000-9995 3-ADDRESSEE COPY

This packaging is the property of the U.S. Postal Service and is provided solely for use in sending Express Mail.
Misuse may be a violation of Federal law.

EP-13C JUNE 2002
© 1996 USPS



**EXPRESS
MAIL**

UNITED STATES POSTAL SERVICE®

EXTREMELY URGENT Please Rush To Addressee

FOR PICKUP OR TRACKING CALL 1-800-222-1811

RECEIVED
BLM AZ STATE OFFICE
1 2015 AUG 27 A 11:06
PHOENIX, ARIZONA

United States Department of the Interior
Bureau of Land Management
 LANDS/RECREATION & PLANNING
 ONE N CENTRAL AVE
 PHOENIX, AZ 85004 -2203
 Phone: 602-417-9200

Receipt

No: 3379899

Transaction #: 3478166	
Date of Transaction: 08/28/2015	
CUSTOMER:	
DENNIS E NOLEN HC 70 BOX 4610 SAHUARITA, AZ 85629-9318 US	

LINE #	QTY	DESCRIPTION	REMARKS	UNIT PRICE	TOTAL
1	1.00	LOCATABLE MINERALS / MINING CLAIMS- NOT NEW-UNADJUD, ONE AUTH NO. ONLY / MINING CLAIM MONEY RECEIVED CASES: AMC414585/\$775.00	MAINT FEE PYMNT - 5 2016	- n/a -	775.00
TOTAL:					\$775.00

PAYMENT INFORMATION			
1	AMOUNT:	775.00	POSTMARKED:
	TYPE:	CHECK	RECEIVED:
	CHECK NO:	584	
	NAME:	NOLEN, TERRY J HC 70 BOX 4610 SAHUARITA AZ 85629-9318 US	

REMARKS

This receipt was generated by the automated BLM Collections and Billing System and is a paper representation of a portion of the official electronic record contained therein.

ENTERED
 AUG 31 2015
 BY: *Rian*

8/28/2015

August 26, 2014

2194
27423
35995

414585

62735

BLM

Enclosed are mining claims
annual assessments.

Dennis Nolen with Patrick Nolen

R# 3117144

(5) claims

\$

775⁰⁰

Helvetia land = Cattle with Sahuarita Mining

(25) claims

\$

3875⁰⁰

Nolen McGee Medema

36 claims

LR# 3117151

\$

5580⁰⁰

Please return stamped copies to

Dennis Nolen

HC 70 Box 4610

Sahuarita AZ

85629

520-625-0980

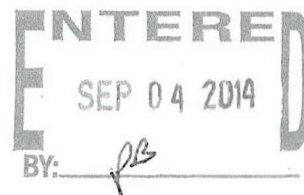

RECEIVED
BLM AZ STATE OFFICE
2014 AUG 28 P 1:35
PHOENIX, ARIZONA

After recording, please return to:

John C. Lacy

DeConcini McDonald Yetwin & Lacy, P.C.

2525 E. Broadway Blvd., #200

Tucson, AZ 85716

STATE OF ARIZONA

)

)ss:

County of Pima

)

CERTIFICATION OF PAYMENT OF MAINTENANCE FEE IN LIEU OF AFFIDAVIT OF ANNUAL ASSESSMENT WORK

Dennis E. Nolen, being first duly sworn, deposes and says that:

1. He is the CEO of Helvetia Land and Cattle Co., one of the owners of the following described unpatented lode mining claims situated in Helvetia Mining District, Pima County, Arizona (the "Claims"), the location notices of which are of record in said county, and in the records of the Arizona State Office of the Bureau of Land Management under the file numbers indicated as follows:

Name of Claim	City Recds	
	Book	Page
WALTHUM	942	87
Amended	5436	812
FLAT TOP	913	600
Amended	5436	813
ROUND TOP	914	1
Amended	5436	814
THE AXE	287	258
Amended	5436	815
SUZY	934	536
Amended	5436	816
ALACHUA	916	549
Amended	5436	817
ELK 32	3368	607
DOE 1	3366	300
ELK 59	3368	634
SHADOW NO. 1	2827	63
BAKER	916	550
LIBERTY	916	559
RUBY	287	256
BOSTON	1750	237
THE ALTA NO. 1	MMM	294
Amended	464	65
AMERICAN NO. 1	MMM	295
Amended	464	63
AMERICAN NO. 2	MMM	293
Amended	464	64

BLM Serial
MC No.

2205

NO. OF CLAIMS 25

2206 AMOUNT \$3875.00

RECEIPT NO. 3117144

2207 INIT. JCA

** BLM-ASO**

2208

2209

2210

27448

27533

36003

36022

62735

62744

62766

62769

62770

62771

62772

62772

62772

62772

RECEIVED
BLM AZ STATE OFFICE
2014 AUG 28 P 1:35

ENTERED
SEP 04 2014
BY: PB

APRICOT	MMM	292	62773
Amended	464	60	
FRENCH KING	MMM	289	62774
Amended	464	67	
ITALIAN QUEEN	MMM	291	62776
Amended	464	71	
SHOVEL	MMM	331	62777
Amended	464	70	
FOUR QUEENS	287	257	62778
CHERRY	MMM	330	62784
Amended	464	66	
RAKE	3869	110	62788
HOE	3869	111	62789

The Claims are situated in Sections 11, 14, 15, 22 and 23, Township 18 South, Range 15 East, G&SR Meridian.

2. Pursuant to the Sections 10101 (a) and (b) of the Omnibus Budget Reconciliation Act of 1993 (Act of August 10, 1993, 107 Stat. 312), as extended by the Department of the Interior and Related Agencies Appropriations Act of October 21, 1998 (P.L. 105-277) and 43 CFR § 3833.1-5(b), the owner has paid a maintenance fee of \$155 per claim for the assessment year beginning September 1, 2014 and this Certificate is in lieu of an affidavit of performance of annual assessment work or notice of intent of hold.

3. The names and address of the owners of Claims for which this Certificate is prepared are: Helvetia Land and Cattle Co., HC 70 Box 4610, Sahuarita, AZ 85629 and Sahuarita Mining 1986, LLC, 5323 N. Camino Real, Tucson, AZ 85718.

THIS IS NOT A CHANGE OF ADDRESS

4. The Claims are held and claimed by the owners for the valuable mineral contained therein.

DATED this 26 day of August, 2014

HELVETIA LAND AND CATTLE CO.

Dennis E. Nolen
Dennis E. Nolen, CEO

The foregoing instrument was acknowledged before me this 26 day of August, 2014, by Dennis E. Nolen, CEO, Helvetia Land and Cattle Co.

Tera L. Weech
Notary Public

My Commission Expires:

4/22/17

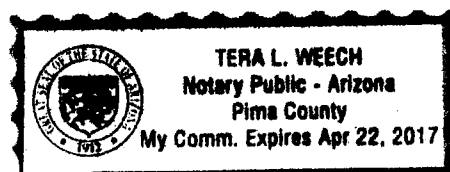

RECEIVED
CLM ASSESSMENT OFFICE
2014 AUG 28 P 1:35
HOE ARIZONA

After recording, please return to:
Dennis E. Nolen
HC 70 Box 4610
Sahuarita, AZ 85629

STATE OF ARIZONA)
)ss:
County of Pima)

**CERTIFICATION OF PAYMENT OF MAINTENANCE FEE IN LIEU OF
AFFIDAVIT OF ANNUAL ASSESSMENT WORK**

NO. OF CLAIMS 5
AMOUNT \$775.00
RECEIPT NO. 311714
INIT. A.H.
** BLM-ASO **

Dennis E. Nolen, being first duly sworn, deposes and says that:

1. He is one of the owners of the following described unpatented lode mining claims situated in the Sierrita Mountains, Pima County, Arizona (the "Claims"), the location notices of which are of record in said county, and in the records of the Arizona State Office of the Bureau of Land Management under the file numbers indicated as follows:

SERIAL NUMBER	NAME OF CLAIM	CLAIMANT'S NAME
AMC 414585	Golden Fleece #5	Dennis E. Nolen
AMC 414586	Golden Fleece #6	Patrick J Nolen
AMC 414587	New Leadville #10	" " " " " " " " " " " "
AMC 414589	Sycamore #3	" " " " " " " " " " " "
AMC 414590	White Bluff #3	" " " " " " " " " " " "

RECEIVED
BLM AZ STATE OFFICE
2014 AUG 28 P 1:35
TUCSON, ARIZONA

The Claims are situated in Section 10, Township 18 South, Range 11 East, G&SR Meridian.

2. Pursuant to the Sections 10101 (a) and (b) of the Omnibus Budget Reconciliation Act of 1993 (Act of August 10, 1993, 107 Stat. 312), as extended by the Department of the Interior and Related Agencies Appropriations Act of October 21, 1998 (P.L. 105-277) and 43 CFR § 3833.1-5(b), the owner has paid a maintenance fee of \$155.00 per claim for the assessment year beginning September 1, 2014 and this Certificate is in lieu of an affidavit of performance of annual assessment work or notice of intent of hold.

ENTERED
SEP 04 2014
BY: 13

3. The names and address of the owners of Claims for which this Certificate is prepared are: Dennis E. Nolen and Patrick J. Nolen, HC 70 Box 4610, Sahuarita, AZ 85629.

THIS IS NOT A CHANGE OF ADDRESS

4. The Claims are held and claimed by the owners for the valuable mineral contained therein.

DATED this 26 day of August, 2014

Dennis E. Nolen
Dennis E. Nolen

The foregoing instrument was acknowledged before me this 26 day of August, 2014, by Dennis E. Nolen.

Tera L. Weech
Notary Public

My Commission Expires:

4/22/17

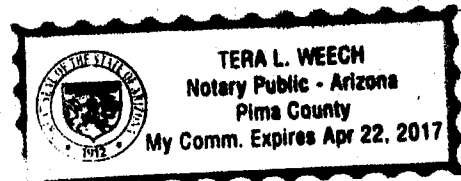

RECEIVED
BLM AZ STATE OFFICE
2014 AUG 28 P 1:35
PHOENIX, ARIZONA

United States Department of the Interior
Bureau of Land Management
 LANDS/RECREATION & PLANNING
 ONE N CENTRAL AVE
 PHOENIX, AZ 85004 -2203
 Phone: 602-417-9200

Receipt

No:

3117144

Transaction #: 3208934	
Date of Transaction: 08/29/2014	
CUSTOMER:	
DENNIS E NOLEN HC 70 BOX 4610 SAHUARITA, AZ 85629-9318 US	

ENTERED
 SEP 04 2014
 BY: *PS*

LINE #	QTY	DESCRIPTION	REMARKS	UNIT PRICE	TOTAL
1	1.00	LOCATABLE MINERALS / MINING CLAIMS-NOT NEW-UNADJUD, ONE AUTH NO. ONLY / MINING CLAIM MONEY RECEIVED CASES: AMC2205/\$4650.00	MAINT FEE PYMNT (30)✓ 2015	- n/a -	4650.00
TOTAL:					\$4,650.00

PAYMENT INFORMATION			
1	AMOUNT:	4650.00	POSTMARKED: 08/26/2014
	TYPE:	CHECK	RECEIVED: 08/28/2014
	CHECK NO:	492	
	NAME:	NOLEN, TERRY J HC 70 BOX 4610 SAHUARITA AZ 85629-9318 US	

REMARKS

This receipt was generated by the automated BLM Collections and Billing System and is a paper representation of a portion of the official electronic record contained therein.

Nolen
HC 70 Box 4610
Sahuarita AZ
85629



7012 2920 0002 1598 0268



1000

85004

U.S. POSTAGE
PAID
SAHUARITA, AZ
85629
AUG 26, 14
AMOUNT
\$7.40
00058388-13

BLM
One N Central Ave
Phoenix AZ
85004-2203

PHOENIX, ARIZONA

2014 AUG 28 P 1:35

RECEIVED
BLM AZ STATE OFFICE

FIRST CLASS

After recording, please return to:

John C. Lacy

DeConcini McDonald Yetwin & Lacy, P.C.

2525 E. Broadway Blvd., #200

Tucson, AZ 85716

STATE OF ARIZONA

County of Pima

)
)ss:
)

AMC 2194
AMC 332724
AMC 414585
AMC 62735
AMC 35995
AMC 27423

CERTIFICATION OF PAYMENT OF MAINTENANCE FEE IN LIEU OF AFFIDAVIT OF ANNUAL ASSESSMENT WORK

Dennis E. Nolen, being first duly sworn, deposes and says that:

1. He is the CEO of Helvetia Land and Cattle Co., one of the owners of the following described unpatented lode mining claims situated in Helvetia Mining District, Pima County, Arizona (the "Claims"), the location notices of which are of record in said county, and in the records of the Arizona State Office of the Bureau of Land Management under the file numbers indicated as follows:

Name of Claim	Cty Recds		BLM Serial MC No.
	Book	Page	
WALTHUM	942	87	2205
Amended	5436	812	
FLAT TOP	913	600	2206
Amended	5436	813	
ROUND TOP	914	1	2207
Amended	5436	814	
THE AXE	287	258	2208
Amended	5436	815	
SUZY	934	536	2209
Amended	5436	816	
ALACHUA	916	549	2210
Amended	5436	817	
ELK 32	3368	607	27448
DOE 1	3366	300	27533
ELK 59	3368	634	36005
SHADOW NO. 1	2827	63	36022
BAKER	916	550	62735
LIBERTY	916	559	62744
RUBY	287	256	62766
BOSTON	1750	237	62769
THE ALTA NO. 1	MMM	294	62770
Amended	464	65	
AMERICAN NO. 1	MMM	295	62771
Amended	464	63	
AMERICAN NO. 2	MMM	293	62772
Amended	464	64	

ENTERED INTO COMPUTER

AUG 21 2013

TS

RECEIVED
BLM AZ STATE OFFICE
PHOENIX, ARIZONA
200 AUG 14 PM 3:15

August 13, 2013

BLM -

Enclosed are three certifications of
Payment of maintenance fee in lieu of
affidavit of annual assessment work.

Total claims 66 x \$140⁰⁰ = \$9240⁰⁰

Check enclosed

Thank-you

Dennis Nolen
Hc 70 Box 4610
Sahuarita AZ
85629

520-625-0980

RECEIVED
BLM AZ
PHOENIX, ARIZONA
JUL 19 2013

NO. OF CLAIMS

AMOUNT

RECEIPT NO.

INIT.

** BLM-ASO **

66
\$9240.00
2855603
DAN

APRICOT	MMM	292	62773
Amended	464	60	
FRENCH KING	MMM	289	62774
Amended	464	67	
ITALIAN QUEEN	MMM	291	62776
Amended	464	71	
SHOVEL	MMM	331	62777
Amended	464	70	
FOUR QUEENS	287	257	62778
CHERRY	MMM	330	62784
Amended	464	66	
RAKE	3869	110	62788
HOE	3869	111	62789

The Claims are situated in Sections 11, 14, 15, 22 and 23, Township 18 South, Range 15 East, G&SR Meridian.

2. Pursuant to the Sections 10101 (a) and (b) of the Omnibus Budget Reconciliation Act of 1993 (Act of August 10, 1993, 107 Stat. 312), as extended by the Department of the Interior and Related Agencies Appropriations Act of October 21, 1998 (P.L. 105-277) and 43 CFR § 3833.1-5(b), the owner has paid a maintenance fee of \$140 per claim for the assessment year beginning September 1, 2013 and this Certificate is in lieu of an affidavit of performance of annual assessment work or notice of intent of hold.

3. The names and address of the owners of Claims for which this Certificate is prepared are: Helvetia Land and Cattle Co., HC 70 Box 4610, Sahuarita, AZ 85629 and Sahuarita Mining 1986, LTD., 5323 N. Camino Real, Tucson, AZ 85718.

THIS IS NOT A CHANGE OF ADDRESS

4. The Claims are held and claimed by the owners for the valuable mineral contained therein.

DATED this 13th day of AUGUST, 2013

HELVETIA LAND AND CATTLE CO.

Dennis E. Nolen
Dennis E. Nolen, CEO

The foregoing instrument was acknowledged before me this 13th day of AUGUST, 2013, by Dennis E. Nolen, CEO, Helvetia Land and Cattle Co.

Norma Santa Maria
Notary Public

My Commission Expires:

09/11/2015

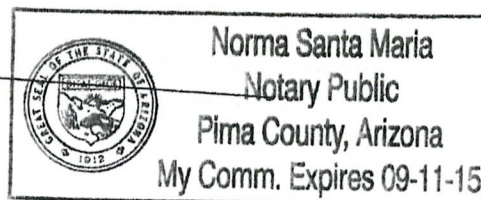

RECEIVED
BLM AZ DISTRICT OFFICE
2013 AUG 14 PM 2:15
CHANDLER, ARIZONA

After recording, please return to:
Dennis E. Nolen
HC 70 Box 4610
Sahuarita, AZ 85629

RECEIVED
BIM ASSESSMENT
JUN 11 2013
PIMA COUNTY, ARIZONA

STATE OF ARIZONA)
)ss:
County of Pima)

**CERTIFICATON OF PAYMENT OF MAINTENANCE FEE IN LIEU OF
AFFIDAVIT OF ANNUAL ASSESSMENT WORK**

Dennis E. Nolen, being first duly sworn, deposes and says that:

1. He is one of the owners of the following described unpatented lode mining claims situated in the Sierrita Mountains, Pima County, Arizona (the "Claims"), the location notices of which are of record in said county, and in the records of the Arizona State Office of the Bureau of Land Management under the file numbers indicated as follows:

SERIAL NUMBER	NAME OF CLAIM	CLAIMANT'S NAME
AMC 414585	Golden Fleece #5	Dennis E. Nolen Patrick J Nolen
AMC 414586	Golden Fleece #6	" " "
AMC 414587	New Leadville #10	" " "
AMC 414589	Sycamore #3	" " "
AMC 414590	White Bluff #3	" " "

The Claims are situated in Section 10, Township 18 South, Range 11 East, G&SR Meridian.

2. Pursuant to the Sections 10101 (a) and (b) of the Omnibus Budget Reconciliation Act of 1993 (Act of August 10, 1993, 107 Stat. 312), as extended by the Department of the Interior and Related Agencies Appropriations Act of October 21, 1998 (P.L. 105-277) and 43 CFR § 3833.1-5(b), the owner has paid a maintenance fee of \$140.00 per claim for the assessment year beginning September 1, 2013, and this Certificate is in lieu of an affidavit of performance of annual assessment work or notice of intent of hold.

3. The names and address of the owners of Claims for which this Certificate is prepared are: Dennis E. Nolen and Patrick J. Nolen, HC 70 Box 4610, Sahuarita, AZ 85629.

THIS IS NOT A CHANGE OF ADDRESS

4. The Claims are held and claimed by the owners for the valuable mineral contained therein.

DATED this 13 day of August, 2013

Dennis E. Nolen
Dennis E. Nolen

The foregoing instrument was acknowledged before me this 13th day of August, 2013, by Dennis E. Nolen.

Norma Santa Maria
Notary Public

My Commission Expires:

09/11/2015

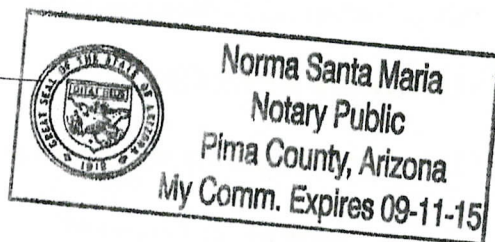

RECEIVED
BLM/ARIZONA
2013 AUG 14 PM 2:15
MICHELLE J. JACOBSON

After recording, please return to:
Dennis E. Nolen
HC 70 Box 4610
Sahuarita, AZ 85629

STATE OF ARIZONA)

County of Pima)

)ss:

CERTIFICATION OF PAYMENT OF MAINTENANCE FEE IN LIEU OF AFFIDAVIT OF ANNUAL ASSESSMENT WORK

Dennis E. Nolen, being first duly sworn, deposes and says that:

1. He is one of the owners of the following described unpatented lode mining claims situated in the Sierrita Mountains, Pima County, Arizona (the "Claims"), the location notices of which are of record in said county, and in the records of the Arizona State Office of the Bureau of Land Management under the file numbers indicated as follows:

See three attached Case Claim sheet

The Claims are situated in Sections 1, 2, 4, 9, 10, 11, 14, 15, and 35, Townships 17 South, and 18 South, Range 11 East, G&SR Meridian.

2. Pursuant to the Sections 10101 (a) and (b) of the Omnibus Budget Reconciliation Act of 1993 (Act of August 10, 1993, 107 Stat. 312), as extended by the Department of the Interior and Related Agencies Appropriations Act of October 21, 1998 (P.L. 105-277) and 43 CFR § 3833.1-5(b), the owner has paid a maintenance fee of \$140 per claim for the assessment year beginning September 1, 2013 and this Certificate is in lieu of an affidavit of performance of annual assessment work or notice of intent of hold.

3. The names and address of the owners of Claims for which this Certificate is prepared are:
Dennis E. Nolen, Louis L. McGee, C.E. Medema, HC 70 Box 4610, Sahuarita, AZ 85629.

THIS IS NOT A CHANGE OF ADDRESS

4. The Claims are held and claimed by the owners for the valuable mineral contained therein.

DATED this 13 day of August, 2013

Dennis E. Nolen
Dennis E. Nolen

¹³ 200¹⁵ The foregoing instrument was acknowledged before me this 13th day of August, by Dennis E. Nolen.

Norma Santa Maria
Notary Public

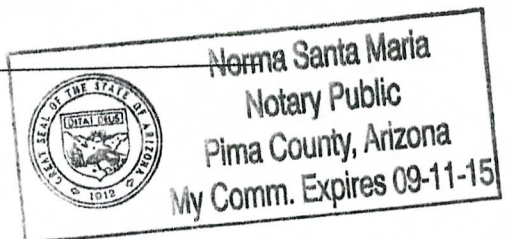

My Commission Expires:

09/11/2015

<u>SERIAL NUMBER</u>	<u>CLAIM NAME</u>	<u>CLAIMANT'S NAME</u>
A MC 332748	New East Star #15	Dennis E. Nolen
A MC 332749	New East Star #16	Louis L. McGee
A MC 332750	New East Star Extension #17	C.E. Medema
A MC 332751	New East Star Extension #19	" " "
A MC 332752	New East Star Extension #20	" " "
A MC 332753	New East Star Extension #21	" " "
A MC 332754	New East Star Extension #22	" " "
A MC 332755	New East Star Extension #25	" " "
A MC 332756	Red Eagle #1	" " "
A MC 332757	Red Eagle #4	" " "
A MC 332758	Red Eagle #10	" " "
A MC 332759	Red Eagle #11	" " "

RECEIVED
BLM AZ STATE OFFICE

PHOENIX, ARIZONA

2013 AUG 14 PM 3:15

<u>SERIAL NUMBER</u>	<u>CLAIM NAME</u>	<u>CLAIMANT'S NAME</u>
A MC 332736	Leadville #5	Dennis E. Nolen Louis L. McGee C.E. Medema
A MC 332737	Leadville #6	" " " " " " " " "
A MC 332738	New Leadville #9	" " " " " " " " "
A MC 332739	Leadville #14	" " " " " " " " "
A MC 332740	May Bird #26	" " " " " " " " "
A MC 332741	New East Star Extension #8	" " " " " " " " "
A MC 332742	New East Star Extension # 9	" " " " " " " " "
A MC 332743	New East Star Extension #10	" " " " " " " " "
A MC 332744	New East Star Extension #11	" " " " " " " " "
A MC 332745	New East Star Extension #12	" " " " " " " " "
A MC 332746	New East Star Extension #13	" " " " " " " " "
A MC 332747	New East Star Extension #14	" " " " " " " " "

RECEIVED
BLM AZ STAFF OFFICE
2013 AUG 14 PM 3:15
PHOENIX, ARIZONA

CASE CLAIM

<u>SERIAL NUMBER</u>	<u>CLAIM NAME</u>	<u>CLAIMANT'S NAME</u>
A MC 332724	Eagle #12	Dennis E. Nolen Louis L. McGee C.E. Medema
A MC 332725	Keystone # 1	" " "
A MC 332726	Keystone #2	" " "
A MC 332727	Keystone #3	" " "
A MC 332728	Keystone #4	" " "
A MC 332729	Keystone #5	" " "
A MC 332730	Keystone #10	" " "
A MC 332731	Keystone #11	" " "
A MC 332732	Keystone #12	" " "
A MC 332733	Keystone #13	" " "
A MC 332734	Keystone #14	" " "
A MC 332735	Leadville #4	" " "

RECEIVED
BLM AZ STATE OFFICE
2013 AUG 14 PM 3:15
PHOENIX, ARIZONA

United States Department of the Interior
Bureau of Land Management
 LANDS/RECREATION & PLANNING
 ONE N CENTRAL AVE
 PHOENIX, AZ 85004 -2203
 Phone: 602-417-9200

Receipt

No: 2855603

Transaction #: 2941397	
Date of Transaction: 08/15/2013	
CUSTOMER:	
	DENNIS E NOLEN HC 70 BOX 4610 SAHUARITA, AZ 85629-9318 US

LINE #	QTY	DESCRIPTION	REMARKS	UNIT PRICE	TOTAL
1	1.00	LOCATABLE MINERALS / MINING CLAIMS-NOT NEW-UNADJUD, ONE AUTH NO. ONLY / MINING CLAIM MONEY RECEIVED CASES: AMC2205/\$9240.00	MAINT FEE PYMNT (66) 2014	- n/a -	9240.00
TOTAL:					\$9,240.00

PAYMENT INFORMATION			
1	AMOUNT:	9240.00	POSTMARKED: 08/13/2013
	TYPE:	CHECK	RECEIVED: 08/14/2013
	CHECK NO:	1135	
	NAME:	DENNY NOLEN CORP HC 70 BOX 4610 SAHUARITA AZ 85629-9318 US	

REMARKS

This receipt was generated by the automated BLM Collections and Billing System and is a paper representation of a portion of the official electronic record contained therein.

Authorized Date10/15/2012

Instructions to AccountsAZ BLM REFUND \$174 TO TERRY J. NOLEN FOR MAINT. AND
LOCATION FEES PAID ON AMC414588 WHICH WAS
NULL&VOID AB INITIO. RECEIPT #2541414. RE.

Login ID4105

Entry Date10/15/2012

Total Amount\$174.00

After recording, please return to:
Dennis E. Nolen
HC 70 Box 4610
Sahuarita, AZ 85629

AMC 332724

414585

62735

35995

27423

2194

Page 1

STATE OF ARIZONA

County of Pima

)
)ss:
)

RECEIVED
BLM AZ STATE OFFICE
2012 AUG 28 PM 1:18
PHOENIX, ARIZONA

CERTIFICATION OF PAYMENT OF MAINTENANCE FEE IN LIEU OF AFFIDAVIT OF ANNUAL ASSESSMENT WORK

Dennis E. Nolen, being first duly sworn, deposes and says that:

1. He is one of the owners of the following described unpatented lode mining claims situated in the Sierrita Mountains, Pima County, Arizona (the "Claims"), the location notices of which are of record in said county, and in the records of the Arizona State Office of the Bureau of Land Management under the file numbers indicated as follows:

See three attached Case Claim sheet

The Claims are situated in Sections 1, 2, 4, 9, 10, 11, 14, 15, and 35, Townships 17 South, and 18 South, Range 11 East, G&SR Meridian.

2. Pursuant to the Sections 10101 (a) and (b) of the Omnibus Budget Reconciliation Act of 1993 (Act of August 10, 1993, 107 Stat. 312), as extended by the Department of the Interior and Related Agencies Appropriations Act of October 21, 1998 (P.L. 105-277) and 43 CFR § 3833.1-5(b), the owner has paid a maintenance fee of \$140 per claim for the assessment year beginning September 1, 2012 and this Certificate is in lieu of an affidavit of performance of annual assessment work or notice of intent of hold.

3. The names and address of the owners of Claims for which this Certificate is prepared are: Dennis E. Nolen, Louis L. McGee, C.E. Medema, HC 70 Box 4610, Sahuarita, AZ 85629.

THIS IS NOT A CHANGE OF ADDRESS

4. The Claims are held and claimed by the owners for the valuable mineral contained therein.

DATED this 24 day of August, 2012

Dennis E. Nolen
Dennis E. Nolen

The foregoing instrument was acknowledged before me this 24 day of August, 2012, by Dennis E. Nolen.

Tera L. Weech
Notary Public

My Commission Expires:

4-22-13

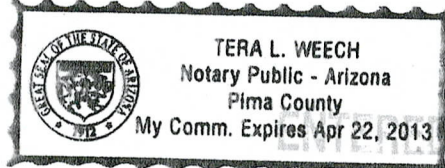

9/18/12 HT

<u>SERIAL NUMBER</u>	<u>CLAIM NAME</u>	<u>CLAIMANT'S NAME</u>
A MC 332736	Leadville #5	Dennis E. Nolen Louis L. McGee C.E. Medema
A MC 332737	Leadville #6	" " "
A MC 332738	New Leadville #9	" " "
A MC 332739	Leadville #14	" " "
A MC 332740	May Bird #26	" " "
A MC 332741	New East Star Extension #8	" " "
A MC 332742	New East Star Extension # 9	" " "
A MC 332743	New East Star Extension #10	" " "
A MC 332744	New East Star Extension #11	" " "
A MC 332745	New East Star Extension #12	" " "
A MC 332746	New East Star Extension #13	" " "
A MC 332747	New East Star Extension #14	" " "

RECEIVED
BLM AZ STATE OFFICE
2012 AUG 28 P 1:18

PHOENIX, ARIZONA

<u>SERIAL NUMBER</u>	<u>CLAIM NAME</u>	<u>CLAIMANT'S NAME</u>
A MC 332748	New East Star #15	Dennis E. Nolen Louis L. McGee C.E. Medema
A MC 332749	New East Star #16	" " "
A MC 332750	New East Star Extension #17	" " "
A MC 332751	New East Star Extension #19	" " "
A MC 332752	New East Star Extension #20	" " "
A MC 332753	New East Star Extension #21	" " "
A MC 332754	New East Star Extension #22	" " "
A MC 332755	New East Star Extension #25	" " "
A MC 332756	Red Eagle #1	" " "
A MC 332757	Red Eagle #4	" " "
A MC 332758	Red Eagle #10	" " "
A MC 332759	Red Eagle #11	" " "

PHOENIX, ARIZONA

2012 AUG 28 P 1:19

RECEIVED
RUMAZ STATE OFFICE

CASE CLAIM

<u>SERIAL NUMBER</u>	<u>CLAIM NAME</u>	<u>CLAIMANT'S NAME</u>
A MC 332724	Eagle #12	Dennis E. Nolen Louis L. McGee C.E. Medema
A MC 332725	Keystone # 1	" " "
		" " "
		" " "
A MC 332726	Keystone #2	" " "
		" " "
		" " "
A MC 332727	Keystone #3	" " "
		" " "
		" " "
A MC 332728	Keystone #4	" " "
		" " "
		" " "
A MC 332729	Keystone #5	" " "
		" " "
		" " "
A MC 332730	Keystone #10	" " "
		" " "
		" " "
A MC 332731	Keystone #11	" " "
		" " "
		" " "
A MC 332732	Keystone #12	" " "
		" " "
		" " "
A MC 332733	Keystone #13	" " "
		" " "
		" " "
A MC 332734	Keystone #14	" " "
		" " "
		" " "
A MC 332735	Leadville #4	" " "
		" " "
		" " "

RECEIVED
BLM AZ STATE OFFICE
2012 AUG 28 P 1:19
PHOENIX, ARIZONA

NO. OF CLAIMS 36+5+25
AMOUNT 9240.00
RECEIPT NO. 2643903
INIT. [Signature]
BLM-ASO

After recording, please return to:
Dennis E. Nolen
HC 70 Box 4610
Sahuarita, AZ 85629

STATE OF ARIZONA)
)ss:
County of Pima)

**CERTIFICATION OF PAYMENT OF MAINTENANCE FEE IN LIEU OF
AFFIDAVIT OF ANNUAL ASSESSMENT WORK**

Dennis E. Nolen, being first duly sworn, deposes and says that:

1. He is one of the owners of the following described unpatented lode mining claims situated in the Sierrita Mountains, Pima County, Arizona (the "Claims"), the location notices of which are of record in said county, and in the records of the Arizona State Office of the Bureau of Land Management under the file numbers indicated as follows:

SERIAL NUMBER	NAME OF CLAIM	CLAIMANT'S NAME
AMC 414585	Golden Fleece #5	Dennis E. Nolen
AMC 414586	Golden Fleece #6	Patrick J Nolen
AMC 414587	New Leadville #10	" " "
AMC 414589	Sycamore #3	" " "
AMC 414590	White Bluff #3	" " "

RECEIVED
BLM AZ STATE OFFICE
2012 AUG 28 P 1:19
PHOENIX, ARIZONA

The Claims are situated in Section 10, Township 18 South, Range 11 East, G&SR Meridian.

2. Pursuant to the Sections 10101 (a) and (b) of the Omnibus Budget Reconciliation Act of 1993 (Act of August 10, 1993, 107 Stat. 312), as extended by the Department of the Interior and Related Agencies Appropriations Act of October 21, 1998 (P.L. 105-277) and 43 CFR § 3833.1-5(b), the owner has paid a maintenance fee of \$140.00 per claim for the assessment year beginning September 1, 2012, and this Certificate is in lieu of an affidavit of performance of annual assessment work or notice of intent to hold.

3. The names and address of the owners of Claims for which this Certificate is prepared are: Dennis E. Nolen and Patrick J. Nolen, HC 70 Box 4610, Sahuarita, AZ 85629.

THIS IS NOT A CHANGE OF ADDRESS

4. The Claims are held and claimed by the owners for the valuable mineral contained therein.

DATED this 24 day of August, 2012

Dennis E. Nolen
Dennis E. Nolen

The foregoing instrument was acknowledged before me this 24 day of August, 2012, by Dennis E. Nolen.

Tera L. Weech
Notary Public

My Commission Expires:

4-22-13

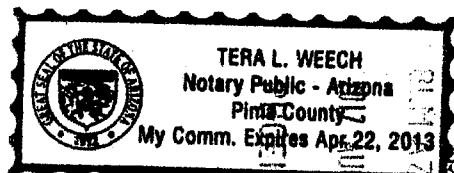

RECEIVED
CLERK OF SUPERIOR COURT
PIMA COUNTY
JUL 28 P 1:19
TULSA, ARIZONA

After recording, please return to:
 John C. Lacy
 DeConcini McDonald Yetwin & Lacy, P.C.
 2525 E. Broadway Blvd., #200
 Tucson, AZ 85716

RECEIVED
 BLM AZ STATE OFFICE
 2012 AUG 28 P 1119
 PHOENIX, ARIZONA

STATE OF ARIZONA)
)ss:
 County of Pima)

CERTIFICATION OF PAYMENT OF MAINTENANCE FEE IN LIEU OF AFFIDAVIT OF ANNUAL ASSESSMENT WORK

Dennis E. Nolen, being first duly sworn, deposes and says that:

1. He is the CEO of Helvetia Land and Cattle Co., one of the owners of the following described unpatented lode mining claims situated in Helvetia Mining District, Pima County, Arizona (the "Claims"), the location notices of which are of record in said county, and in the records of the Arizona State Office of the Bureau of Land Management under the file numbers indicated as follows:

Name of Claim	City Recds		BLM Serial MC No.
	Book	Page	
WALTHUM	942	87	2205
Amended	5436	812	
FLAT TOP	913	600	2206
Amended	5436	813	
ROUND TOP	914	1	2207
Amended	5436	814	
THE AXE	287	258	2208
Amended	5436	815	
SUZY	934	536	2209
Amended	5436	816	
ALACHUA	916	549	2210
Amended	5436	817	
ELK 32	3368	607	27448
DOE 1	3366	300	27533
ELK 59	3368	634	36005
SHADOW NO. 1	2827	63	36022
BAKER	916	550	62735
LIBERTY	916	559	62744
RUBY	287	256	62766
BOSTON	1750	237	62769
THE ALTA NO. 1	MMM	294	62770
Amended	464	65	
AMERICAN NO. 1	MMM	295	62771
Amended	464	63	
AMERICAN NO. 2	MMM	293	62772
Amended	464	64	

APRICOT	MMM	292	62773
Amended	464	60	
FRENCH KING	MMM	289	62774
Amended	464	67	
ITALIAN QUEEN	MMM	291	62776
Amended	464	71	
SHOVEL	MMM	331	62777
Amended	464	70	
FOUR QUEENS	287	257	62778
CHERRY	MMM	330	62784
Amended	464	66	
RAKE	3869	110	62788
HOE	3869	111	62789

RECEIVED
 CLM AZ STATE OFFICE
 2012 AUG 28 P 1:19

The Claims are situated in Sections 11, 14, 15, 22 and 23, Township 18 South, Range 15 East, G&SR Meridian.

2. Pursuant to the Sections 10101 (a) and (b) of the Omnibus Budget Reconciliation Act of 1993 (Act of August 10, 1993, 107 Stat. 312), as extended by the Department of the Interior and Related Agencies Appropriations Act of October 21, 1998 (P.L. 105-277) and 43 CFR § 3833.1-5(b), the owner has paid a maintenance fee of \$140 per claim for the assessment year beginning September 1, 2012 and this Certificate is in lieu of an affidavit of performance of annual assessment work or notice of intent of hold.

3. The names and address of the owners of Claims for which this Certificate is prepared are: Helvetia Land and Cattle Co., HC 70 Box 4610, Sahuarita, AZ 85629 and Sahuarita Mining 1986, LTD., 5323 N. Camino Real, Tucson, AZ 85718.

THIS IS NOT A CHANGE OF ADDRESS

4. The Claims are held and claimed by the owners for the valuable mineral contained therein.

DATED this 24 day of August, 2012

HELVETIA LAND AND CATTLE CO.

Dennis E. Nolen
 Dennis E. Nolen, CEO

The foregoing instrument was acknowledged before me this 24 day of August, 2012, by Dennis E. Nolen, CEO, Helvetia Land and Cattle Co.

Tera L. Weech
 Notary Public

My Commission Expires:

4-22-13

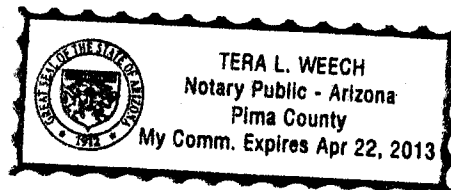

United States Department of the Interior
Bureau of Land Management
 LANDS/RECREATION & PLANNING
 ONE N CENTRAL AVE
 PHOENIX, AZ 85004 -2203
 Phone: 602-417-9200

Receipt

No: 2643903

Transaction #: 2724645	
Date of Transaction: 08/29/2012	
CUSTOMER:	
DENNIS E NOLEN HC 70 BOX 4610 SAHUARITA, AZ 85629-9318 US	

LINE #	QTY	DESCRIPTION	REMARKS	UNIT PRICE	TOTAL
1	1.00	LOCATABLE MINERALS / MINING CLAIMS- NOT NEW-UNADJUD, ONE AUTH NO. ONLY / MINING CLAIM MONEY RECEIVED CASES: AMC332724/\$9240.00	2013 MAINT (66)	- n/a -	9240.00
TOTAL:					\$9,240.00

PAYMENT INFORMATION			
1	AMOUNT:	9240.00	POSTMARKED: N/A
	TYPE:	CHECK	RECEIVED: 08/27/2012
	CHECK NO:	1038	
	NAME:	DENNY NOLEN CORP NOLEN, DENNIS E HC 70 BOX 4610 SAHUARITA AZ 85629-9318 US	

REMARKS

This receipt was generated by the automated BLM Collections and Billing System and is a paper representation of a portion of the official electronic record contained therein.

Lead #s (19)
Amc 332724
414585
2194
27423
35995
62735

NOTICE!!

These documents have been scanned!

Do not place un-scanned documents beneath this notice!

Do not remove this notice from this file!

GPO Jacket No. 560-102
Print Order 61540
Rise Business Services, LLC
Job=AZ15 5/14/2019



Box Number= AZ15049



Claim Begin-End: AMC414585-AMC414590

6 Location Notices-Amendments and Supporting Documents



AZ15049-14

AMC414434-AMC414683

MINING CLAIM STATUS REPORT

DATA
ENTERED

APR 04 2012 *pb*

MTP Checked by APR 02 2012 *pb*

GEO Checked by APR 02 2012 *pb*

LEAD SERIAL NUMBER

AMC

414585

thru

AMC

414590

OF CLAIMS & TYPE

6 LODE

PLACER

ASSOCIATION PLACER

MILL SITE

TUNNEL SITE

CHARGES

Location Fee @ \$34 = \$ *204.00*

Processing Fee @ \$15 = \$ *90.00*

Maintenance Fee @ \$140 = \$ *840.00*

Overage (+) \$

Shortage (-) \$

Other Fees \$

TOTAL \$ *1134.00*

ARE THERE ENOUGH LOCATORS?

Yes ☒ No ☐ *24.66*

DOCUMENTS RECEIVED VIA -

Over-the-Counter ☐ Mail ☒

TIMELY FILED?

Yes ☒ No ☐

LEGAL DESCRIPTION -

T *18S* R *11E*

SEC *10*

T R

SEC

T R

SEC

T R

SEC

BLM ☐ FOREST SERVICE ☐ SUBJ TO PL 359: Yes ☐ No ☐

WILDERNESS AREA: No ☐ Yes ☐

SPLIT ESTATE - N/A ☐ SX ☐ PX ☐ SRHA ☐ OTHER ☐

Proper Notice Filed if Located on SHRA Lands? N/A ☐ Yes ☐ No ☐

RECONVEYED MINERALS ON BLM LANDS REQUIRE OPENING ORDERS FROM 1944 TO 1993 -

Open to Entry on: N/A ☐

COMMENTS/STATUS - VOID ☐ PARTIALLY VOID ☐ PVT MINERALS ☐ WITHDRAWN LANDS ☐

OTHER ☐ *SHOULD AMEND LLD lacks quarter-section, therefore, map used*

LAND IS SRHE - no NOITL filed

AMC 414586-7

AMC 414585 - predominantly - will get NOTICE

AMC 414588 - is completely on NOITL lands - will receive a N.V. closure dec.

AMC 414589-90 - are both predominantly on NOITL - will receive NOTICE

Claimant acknowledges that portions of the following claim(s) site(s) may be void or voidable.

Printed Name of Claimant

Signature of Claimant

***** FINAL ADJUDICATION *****

DATE *10-27-12*

INITIALS *RE*

AMC 414585

3/22/12

Bureau of Land Management
One N Central Ave
Phoenix AZ
85004-2203

RE: Relocation Mining Claims

Please note - enclosed six
mining claims @ \$189⁰⁰ per
claim = \$1134⁰⁰ Check enclosed

Thank-you
Dennis Nolen
HC 70 Box 4610
Sahuarita AZ
85629
520-625-0980

RECEIVED
BLM AZ STATE OFFICE
2012 MAR 29 P 1:17
PHOENIX, ARIZONA



Denny Nolen
HC 70 Box 4610
Sahuarita, AZ 85629

Bureau of Land Management

1 N

Phoenix



85004-2203

Documents

RECEIVED
BLMAZ STATE OFFICE

2012 MAR 29 P 1:17

PHOENIX, ARIZONA

FAST MAIL INC
(520) 281-1650
FAST MAIL INC
204 W. MARIPOSA RD. SUITE 22
NOGALES AZ 85621-1007

1 LBS

1 OF 1

SHIP TO:

BUREAU OF LAND MANAGEMENT
1 N CENTRAL AVE

PHOENIX AZ 85004-2203



AZ 850 9-04



UPS GROUND

TRACKING #: 1Z 100 49R 03 4147 9489



BILLING: P/P

WS 14.0.21 Eltron LP2044 24.0A 01/2012



International Shipping Notice - Carriage hereunder may be subject to the rules relating to liability and other terms and conditions established by the Convention for the Unification of Certain Rules Relating to International Carriage by Air (the "Warsaw Convention") and/or the Convention on the Contract for the International Carriage of Goods by Road (the "CMR Convention"). These commodities, technology or software were exported from the U.S. in accordance with the Export Administration Regulations. Diversion contrary to U.S. law prohibited.



SEQUENCE: 20120580039
NO. PAGES: 2
LOCATN 02/27/2012
11:17
MAIL
AMOUNT PAID: \$10.00

W
DENNIS NOLEN
HC 70 BOX 4610
SAHUARITA AZ 85629

City/State/Zip Code: _____

Space above this line for Recorder's use

NOTICE OF MINING CLAIM

RECEIVED
BLM AZ STATE OFFICE
2012 MAR 29 P 1:18
PHOENIX, ARIZONA

1. TYPE OF NOTICE: ☐ Location ☐ Amendment ☒ Relocation
2. TYPE OF CLAIM: ☐ Placer ☒ Lode ☐ Millsite ☐ Tunnelsite
3. The name and address of the Locator is
Name: Nolen
Address: HC 70 Box 4610
City/State/Zip Code: Sahuarita, Ariz 85629
4. The name of the claim is Golden Fleece #5
5. The date of the location is 2/27/2012
6. The claim is 1500 feet long and 600 feet wide. The distance from the location monument to each end of the claim is 150 feet in a N direction and 1350 feet in a S direction.
7. The general course of the claim is from the N to the S
8. The location of the claim is in Section 10, Township 18S, Range 11E
G + SR Base and Meridian,
Sierrita Mining District, Pima County,
State of Ariz.
9. If amending or relocating, the previous claim name was Golden Fleece #5
recorded in Docket(Book) 4752 page(s) 348-349,
Sierrita Mining District, Pima County,
State of _____
10. The location of the claim with reference to a natural object or permanent monument is 1/4 mile
easterly from Keystone Peak in SEC 10
R 11 E T 18 S

Dated: 2/27/2012

DH Nolen

Dennis E. Nolen

Signature

HC 70 Box 4610

Address

Sahuarita Az 85629

City/State/Zip

MINING CLAIM LOCATION

- The name of the claim is Golden Fleece #5 ;
- The NW corner of the claim is 1200 feet in a N direction to a survey monument or permanent natural object described as Keystone Peak ;
- The type of location monument is Rock Post ;
The type of corner end monuments are Rock ;
- The bearing and distance between the corners of the claim are beginning at the NW corner of the claim, 600 feet in a SE direction to the NE corner, then 1500 feet in a SW direction to the SE corner, then 600 feet in a NW direction to the SW corner, then 1500 feet in a NE direction to the point of beginning.

MAP

One inch = One thousand feet

North Arrow



ONE MILE

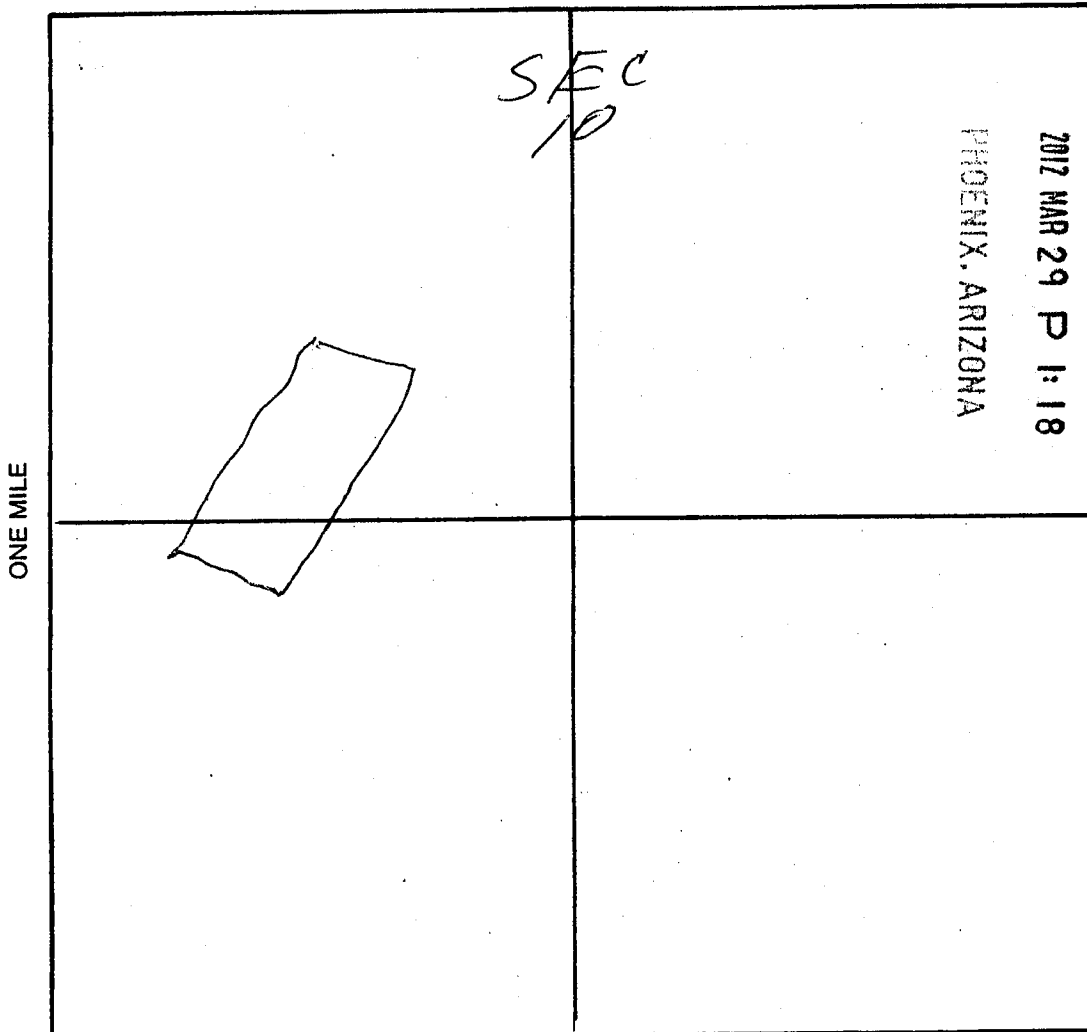

RECEIVED
BLM AZ STATE OFFICE 640 ACRES

2012 MAR 29 P 1:18
PHOENIX, ARIZONA

AMC414585

Section Sec 10 Range 11 E Township 18 S

G + SR Base and Meridian.

Dated: 2/27/2012 Signature Donnie E. Folsom

F. ANN RODRIGUEZ RECORDER
Recorded By: LD
DEPUTY RECORDER
41



SEQUENCE: 20120580040
NO. PAGES: 2
LOCATN 02/27/2012
11:17
MAIL
AMOUNT PAID: \$10.00

W
DENNIS NOLEN
HC 70 BOX 4610
SAHUARITA AZ 85629

City/State/Zip Code: _____

Space above this line for Recorder's use

NOTICE OF MINING CLAIM

RECEIVED
BLM AZ STATE OFFICE
2012 MAR 29 P 1:18
PHOENIX, ARIZONA

1. TYPE OF NOTICE: ☐ Location ☐ Amendment ☒ Relocation
2. TYPE OF CLAIM: ☐ Placer ☒ Lode ☐ Millsite ☐ Tunnelsite
3. The name and address of the Locator is
Name: Nolen
Address: HC 70 Box 4610
City/State/Zip Code: Sahuarita, Az 85629
4. The name of the claim is Golden Fleece #6
5. The date of the location is 2/27/2012
6. The claim is 1500 feet long and 600 feet wide. The distance from the location monument to each end of the claim is 300 feet in a N direction and 1200 feet in a S direction.
7. The general course of the claim is from the S to the N
8. The location of the claim is in Section 10, Township 18 S, Range 11 E, GSR Base and Meridian, Sierrita Mining District, Pima County, State of Az
9. If amending or relocating, the previous claim name was Golden Fleece #6 recorded in Docket(Book) 4752 page(s) 350-351, Sierrita Mining District, Pima County, State of Ariz
10. The location of the claim with reference to a natural object or permanent monument is 1/4 mile easterly from Keystone Peak in sec 10 R11E T 18 S

Dated: 2/27/2012

[Signature]

Dennis E. Nolen
Signature
Hc 70 Box 4610
Address
Sahuarita Az 85629
City/State/Zip

MAP OF MINING CLAIM LOCATION

1. The name of the claim is Golden Fleece #6;
2. The 1000 corner of the claim is 1000 feet in a N direction to a survey monument or permanent natural object described as Keystone Peak in the NW 1/4 of sec 10 T18S R11E;
3. The type of location monument is Rock Post;
The type of corner end monuments are Rock;
4. The bearing and distance between the corners of the claim are beginning at the NW corner of the claim, 600 feet in a ~~SE~~ SE direction to the ~~SW~~ NE corner, then 1500 feet in a ~~SE~~ SW direction to the SE corner, then 600 feet in a NW direction to the SW corner, then 1500 feet in a NE direction to the point of beginning.

MAP

One inch = One thousand feet

North Arrow



ONE MILE

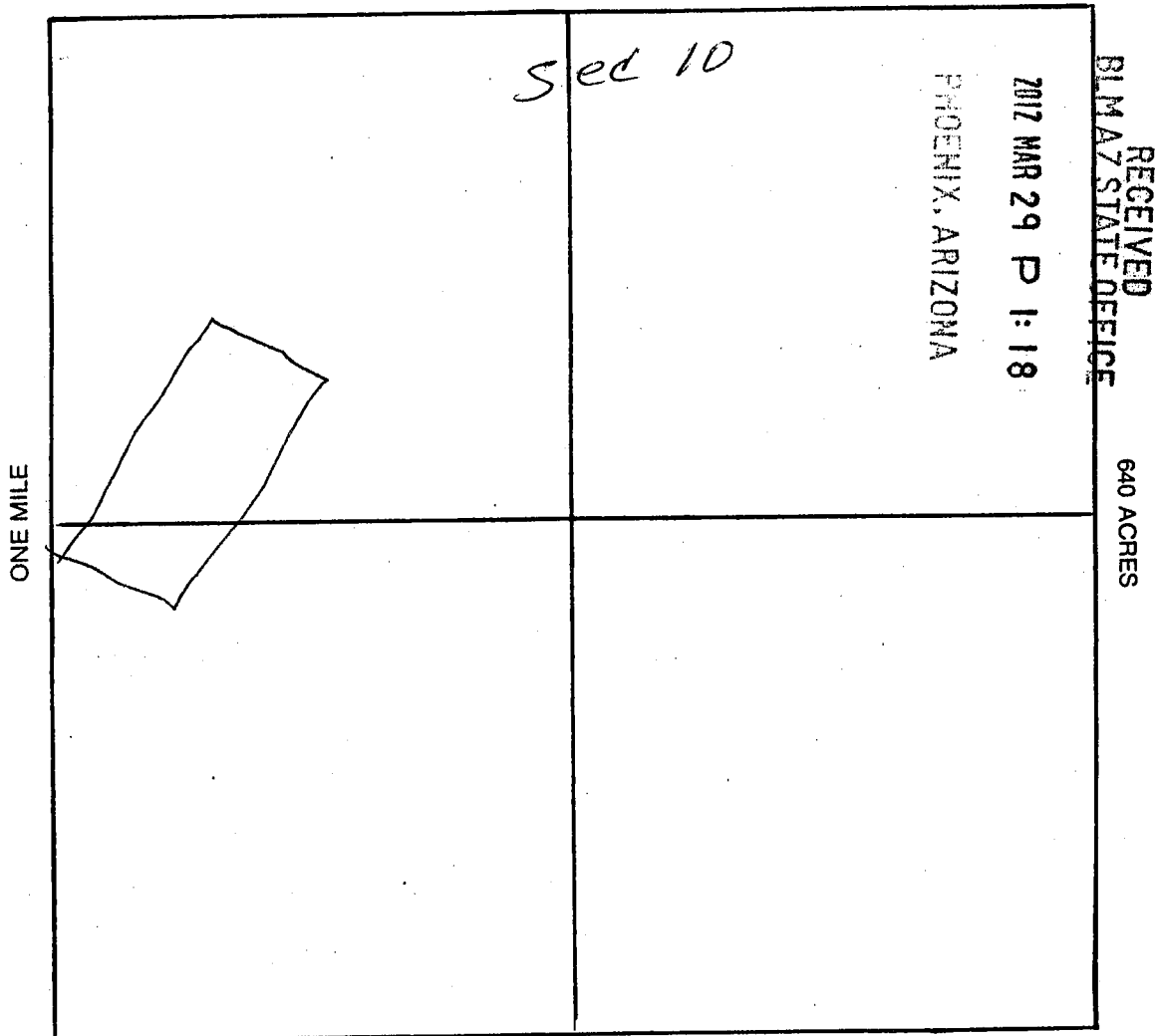

Section 10 Range 11 E Township 18 S
G + SR Base and Meridian.
 Dated: 2/27/2012 Signature Dennis E. Nolan

W

DENNIS NOLEN

HC 70 BOX 4610

SAHUARITA AZ 85629



SEQUENCE: 20120580041

NO. PAGES: 2

LOCATN 02/27/2012

11:17

MAIL

AMOUNT PAID: \$10.00

City/State/Zip Code: _____

Space above this line for Recorder's use

NOTICE OF MINING CLAIM

RECEIVED
BLM AZ STATE OFFICE
2012 MAR 29 P 1:18
PHOENIX, ARIZONA1. TYPE OF NOTICE: ☐ Location ☐ Amendment ☒ Relocation2. TYPE OF CLAIM: ☐ Placer ☒ Lode ☐ Millsite ☐ Tunnel site

3. The name and address of the Locator is

Name: NolenAddress: Hc 70 Box 4610City/State/Zip Code: Sahuarita, Az 856294. The name of the claim is New Leadville #105. The date of the location is 2-27-126. The claim is 1500 feet long and 600 feet wide. The distance from the location monument to each end of the claim is 90 feet in a W direction and 1410 feet in a E direction.7. The general course of the claim is from the E to the W8. The location of the claim is in Section 10, Township 18 S, Range 11 EG + SRBase and Meridian, Sierrita Mining District, Pima County, State of Sierrita Az9. If amending or relocating, the previous claim name was New Leadville #10recorded in Docket(Book) 3570 page(s) 251SierritaMining District, Pima County,State of Az10. The location of the claim with reference to a natural object or permanent monument is 1/4 mile easterly from keystone PeakDated: 2-27-12

Signature

Hc 70 Box 4610

Address

Sahuarita Az 85629

City/State/Zip

MINING CLAIM LOCATION

1. The name of the claim is New Leadville # 10;
2. The NW corner of the claim is 900 feet in a W direction to a survey monument or permanent natural object described as Keystone;
3. The type of location monument is Stone & Post;
The type of corner end monuments are Stone;
4. The bearing and distance between the corners of the claim are beginning at the NW corner of the claim, 1500 feet in a SE direction to the SE corner, then 600 feet in a SW direction to the SW corner, then 1500 feet in a NW direction to the NW corner, then 600 feet in a NE direction to the point of beginning.

MAP

One inch = One thousand feet

North Arrow



ONE MILE

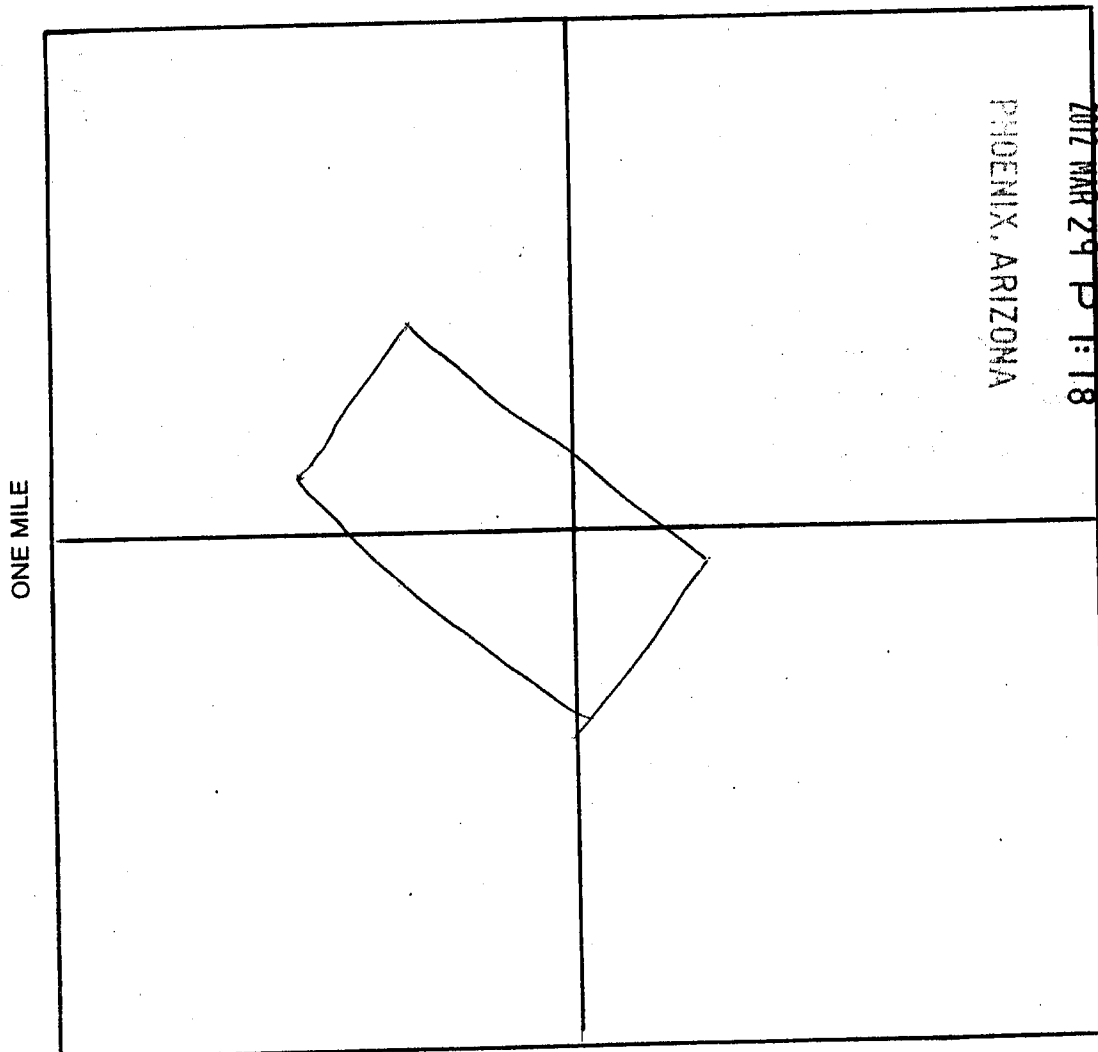

RECEIVED
BLM AZ STATE OFFICE

640 ACRES

AMC 414587

Section 10 Range 11E Township 18S Base and Meridian.

Dated: 2-27-12

Dennis E. [Signature]
Signature

DEPUTY RECORDER
41

W
DENNIS NOLEN
HC 70 BOX 4610
SAHUARITA AZ 85629



SEQUENCE: 20120580042
NO. PAGES: 2
LOCATN 02/27/2012 11:17
MAIL
AMOUNT PAID: \$10.00

City/State/Zip Code: _____

Space above this line for Recorder's use

NOTICE OF MINING CLAIM

RECEIVED
BIMAZ STATE OFFICE
2012 MAR 29 P 1:18
PHOENIX, ARIZONA

1. TYPE OF NOTICE: ☐ Location ☐ Amendment ☒ Relocation
2. TYPE OF CLAIM: ☐ Placer ☒ Lode ☐ Millsite ☐ Tunnelsite
3. The name and address of the Locator is
Name: Nolen
Address: Hc 70 Box 4610
City/State/Zip Code: Sahuarita Az 85629
4. The name of the claim is New Leadville #11
5. The date of the location is 2-27-12
6. The claim is 1500 feet long and 600 feet wide. The distance from the location monument to each end of the claim is 50 feet in a Westerly direction and 1450 feet in a Easterly direction.
7. The general course of the claim is from the East to the West
8. The location of the claim is in Section 10, Township 18 S, Range 11 E, G & SR Base and Meridian, Sierrita Mining District, Pima County, State of AZ
9. If amending or relocating, the previous claim name was New Leadville #11 recorded in Docket(Book) 3570 page(s) 252, Sierrita Mining District, Pima County, State of AZ
10. The location of the claim with reference to a natural object or permanent monument is 1/4 mile in a Northwesterly direction from Keystone Peak

Dated: 2-27-12

Dennis E. Nolen
Signature

Hc 70 Box 4610
Address

Sahuarita Az 85629
City/State/Zip

MAP OF MINING CLAIM LOCATIONS

1. The name of the claim is New Leadville #11 ;
2. The NW corner of the claim is 1300 feet in a NE direction to a survey monument or permanent natural object described as Keystone Peak ;
3. The type of location monument is stone ;
The type of corner end monuments are stone & Posts ;
4. The bearing and distance between the corners of the claim are beginning at the NW corner of the claim, 600 feet in a SW direction to the SW corner, then 1500 feet in a SE direction to the SE corner, then 600 feet in a NE direction to the NE corner, then 1500 feet in a NW direction to the point of beginning.

MAP

One inch = One thousand feet

North Arrow



ONE MILE

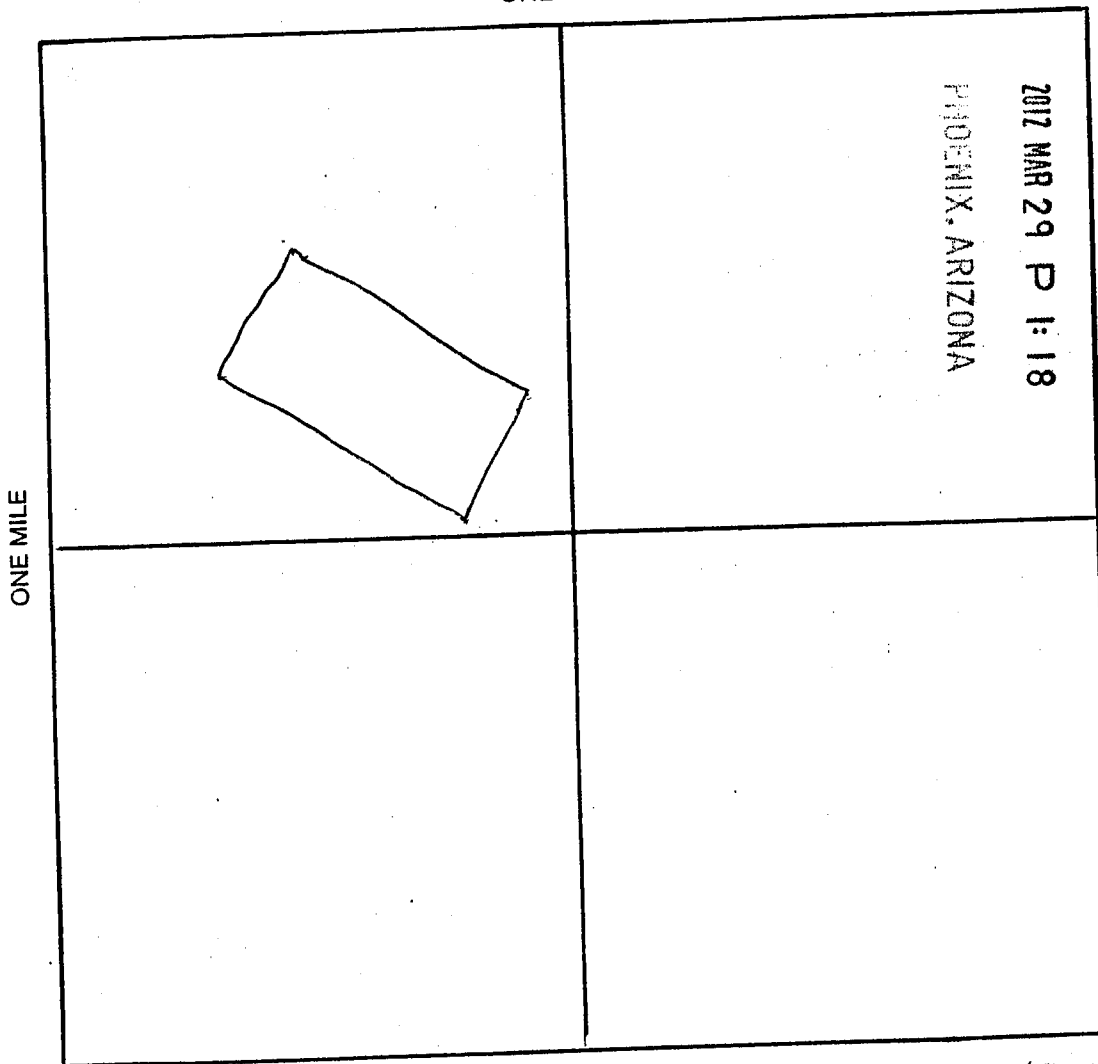

Section 10 Range 11 E Township 18 S Base and Meridian.
G & SR
 Dated: 2-27-12 Signature Dennis E. [Signature]

DEPUTY RECORDER
41

W
DENNIS NOLEN
HC 70 BOX 4610
SAHUARITA AZ 85629



SEQUENCE: 20120580037
NO. PAGES: 2
LOCATN 02/27/2012
11:17
MAIL
AMOUNT PAID: \$10.00

City/State/Zip Code: 85629

Space above this line for Recorder's use

NOTICE OF MINING CLAIM

1. TYPE OF NOTICE: ☐ Location ☐ Amendment ☒ Relocation
2. TYPE OF CLAIM: ☐ Placer ☒ Lode ☐ Millsite ☐ Tunnelsite
3. The name and address of the Locator is
Name: Dennis Nolen
Address: HC 70 Box 4610
City/State/Zip Code: Sahuarita, Ariz 85629
4. The name of the claim is Sycamore #3
5. The date of the location is 2/27/2012
6. The claim is 1500 feet long and 600 feet wide. The distance from the location monument to each end of the claim is 300 feet in a Westerly direction and 1200 feet in a Easterly direction.
7. The general course of the claim is from the East to the West
8. The location of the claim is in Section 10, Township 11 E Range 18 S
G + SR Base and Meridian,
Sierrita Mining District, Pima County,
State of Ariz
9. If amending or relocating, the previous claim name was Sycamore #3
Sierrita recorded in Docket(Book) 1 page(s)
Sierrita Mining District, Pima County,
State of Ariz
10. The location of the claim with reference to a natural object or permanent monument is South side of Plover Peak bounded on South by White Bluffs #3

Dated: 2/27/12
[Signature]
Signature
HC 70 Box 4610
Address
Sahuarita Ariz 85629
City/State/Zip

MAP OF MINING CLAIM LOCATIONS

1. The name of the claim is Sycamore #3;
2. The NW corner of the claim is 100 feet in a SW direction to a survey monument or permanent natural object described as Placer Peak;
3. The type of location monument is Rocks + Post;
The type of corner end monuments are Rock;
4. The bearing and distance between the corners of the claim are beginning at the NW corner of the claim, 600 feet in a SW direction to the SW corner, then 1500 feet in a SE direction to the SE corner, then 600 feet in a NE direction to the NE corner, then 1500 feet in a NW direction to the point of beginning.

MAP

One inch = One thousand feet

North Arrow



ONE MILE

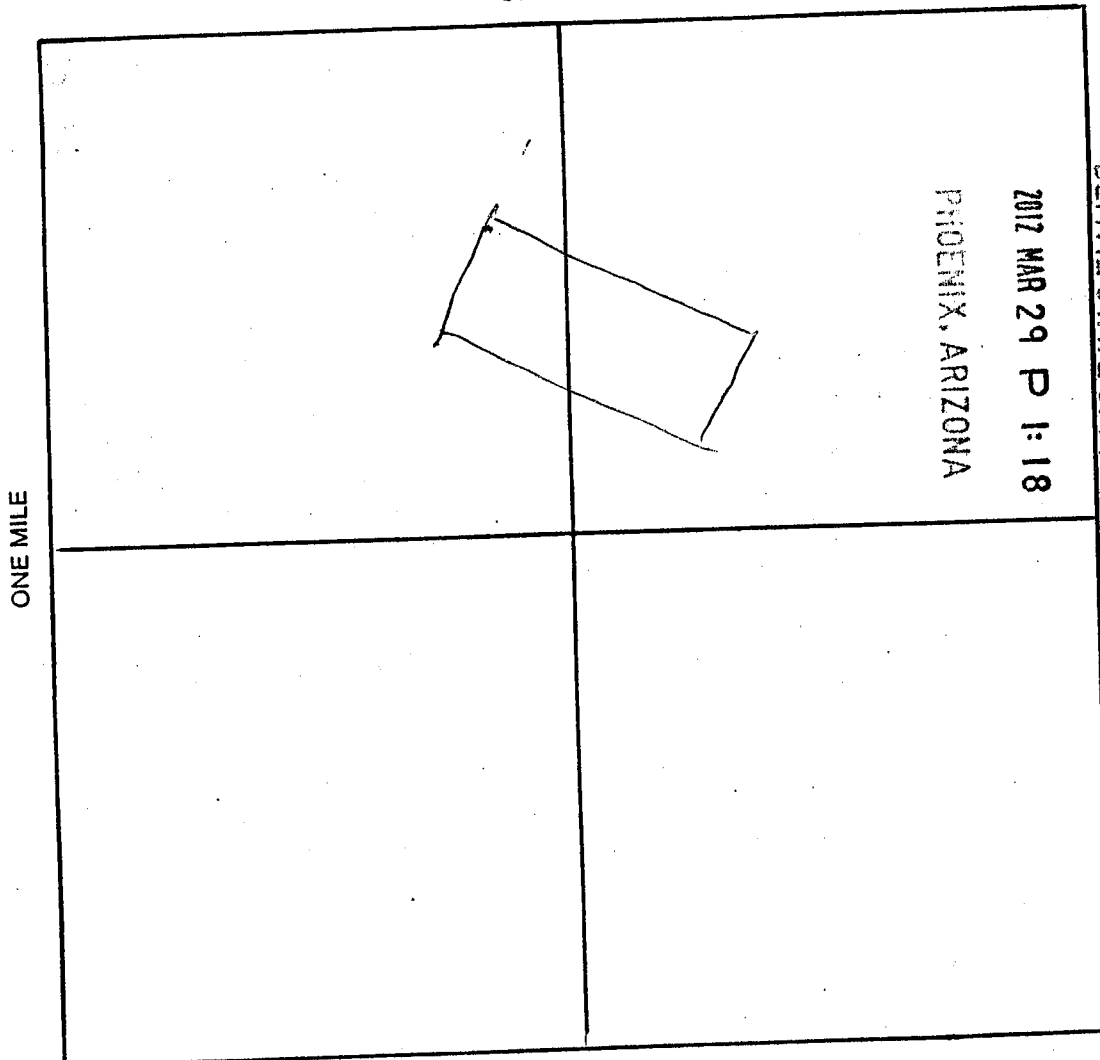

RECEIVED
BLM AZ STATE OFFICE
360 ACRES

2012 MAR 29 P 1:18
PHOENIX, ARIZONA

AMC414589

Section 10 Range 11 E Township 18 S
G + SR Base and Meridian.
Dated: 2/27/12 Signature Dennis E. [Signature]

DEPUTY RECORDER
41

W
DENNIS NOLEN
HC 70 BOX 4610
SAHUARITA AZ 85629



SEQUENCE: 20120580038
NO. PAGES: 2
LOCATN 02/27/2012
11:17
MAIL
AMOUNT PAID: \$10.00

City/State/Zip Code: _____

Space above this line for Recorder's use

NOTICE OF MINING CLAIM

RECEIVED
BLM AZ STATE OFFICE
2012 MAR 29 P 1:18
PHOENIX, ARIZONA

1. TYPE OF NOTICE: ☐ Location ☐ Amendment ☒ Relocation
 2. TYPE OF CLAIM: ☐ Placer ☒ Lode ☐ Millsite ☐ Tunnelsite
 3. The name and address of the Locator is
Name: Nolen
Address: Hc 70 Box 4610
City/State/Zip Code: Sahuarita, Az 85629
 4. The name of the claim is White Bluff #3
 5. The date of the location is 2/27/12
 6. The claim is 1500 feet long and 600 feet wide. The distance from the location monument to each end of the claim is 1200 feet in a NW direction and 300 feet in a SE direction.
 7. The general course of the claim is from the NW to the SE
 8. The location of the claim is in Section 10, Township 18 S, Range 11 E
G + SR B Base and Meridian,
Sierrita Mining District, Pima County,
State of Az
 9. If amending or relocating, the previous claim name was Same
Sierrita recorded in Docket(Book) 2740 page(s) 196
Sierrita Mining District, Pima County,
State of Az
 10. The location of the claim with reference to a natural object or permanent monument is
On southside of Placer Peak, This claim is
bounded on the North by Sycamore #3
- Dated: 2/27/12
PA / th
Dennis E Nolen Signature
Hc 70 Box 4610 Address
Sahuarita, Az 85629 City/State/Zip

MAP OF MINING CLAIM LOCATION

1. The name of the claim is White Bluff #3
2. The NW corner of the claim is 600 feet in a SW direction to a survey monument or permanent natural object described as Apex of Placer Peak
3. The type of location monument is Rocks & Post
The type of corner end monuments are Rock
4. The bearing and distance between the corners of the claim are beginning at the NW corner of the claim, 600 feet in a SW direction to the SW corner, then 1500 feet in a SE direction to the SE corner, then 600 feet in a NE direction to the NE corner, then 1500 feet in a NW direction to the point of beginning.

MAP

One inch = One thousand feet

North Arrow



ONE MILE

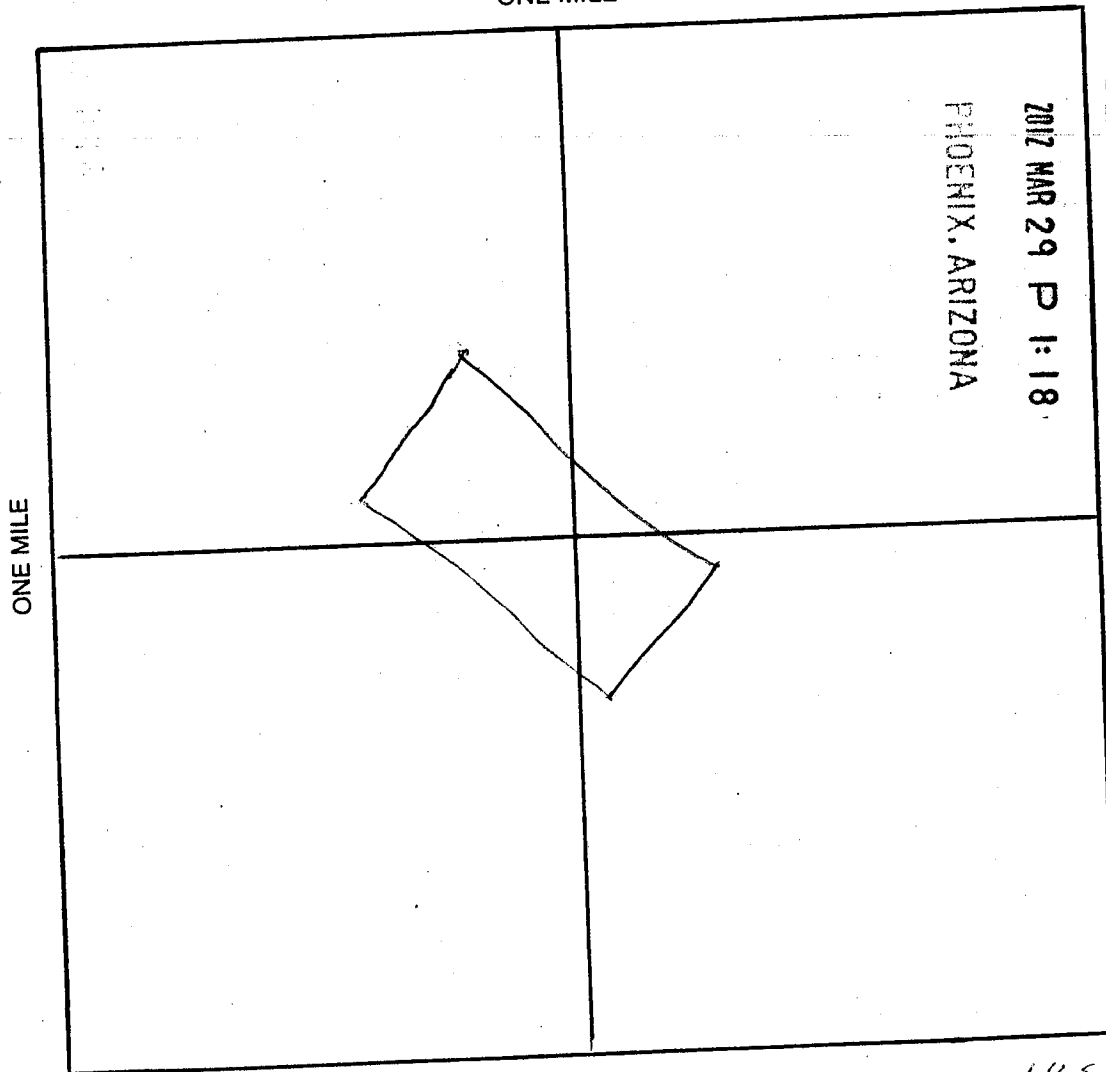

Section 10 Range HE Township 18S Base and Meridian.

Dated: 2/27/12

Dennis E. Tolson
Signature

RUN TIME: 03:10 PM

Adm State: AZ

UNITED STATES DEPARTMENT OF INTERIOR
BUREAU OF LAND MANAGEMENT
GEOGRAPHIC REPORT WITH LAND
Sorted by Meridian Township Range

RUN DATE: 04/02/2012
Page 1 of 2

Serial Number: AZA 009630

Total Case Acres: 3.202

<u>Casetype</u>	<u>Case Disp</u>	14	0180S	0110E	<u>Sect</u>	<u>Sur Typ</u>	<u>Sur Num</u>	<u>Suff</u>	<u>Subdivision</u>	<u>Act Pend</u>
286001	AUTHORIZED				010	MNR		1	NWNWSW;	

Serial Number: AZA 018418

Total Case Acres: 1.580

<u>Casetype</u>	<u>Case Disp</u>	14	0180S	0110E	<u>Sect</u>	<u>Sur Typ</u>	<u>Sur Num</u>	<u>Suff</u>	<u>Subdivision</u>	<u>Act Pend</u>
285003	AUTHORIZED				010	ALIQ			NWNE,NWSW;	

Serial Number: AZA 022769

Total Case Acres: 0.009

<u>Casetype</u>	<u>Case Disp</u>	14	0180S	0110E	<u>Sect</u>	<u>Sur Typ</u>	<u>Sur Num</u>	<u>Suff</u>	<u>Subdivision</u>	<u>Act Pend</u>
289001	AUTHORIZED				010	ALIQ			NWSW;	Y

Serial Number: AZA 024203

Total Case Acres: 1.000

<u>Casetype</u>	<u>Case Disp</u>	14	0180S	0110E	<u>Sect</u>	<u>Sur Typ</u>	<u>Sur Num</u>	<u>Suff</u>	<u>Subdivision</u>	<u>Act Pend</u>
286001	AUTHORIZED				010	ALIQ			NWSW;	Y

Serial Number: AZA 024495

Total Case Acres: 1.000

<u>Casetype</u>	<u>Case Disp</u>	14	0180S	0110E	<u>Sect</u>	<u>Sur Typ</u>	<u>Sur Num</u>	<u>Suff</u>	<u>Subdivision</u>	<u>Act Pend</u>
286001	AUTHORIZED				010	ALIQ			NWSW;	

RUN TIME: 03:10 PM

Adm State: AZ

UNITED STATES DEPARTMENT OF INTERIOR
BUREAU OF LAND MANAGEMENT
GEOGRAPHIC REPORT WITH LAND
Sorted by Meridian Township Range

RUN DATE: 04/02/2012
Page 2 of 2

Serial Number: AZA 028087

Total Case Acres: 0.020

<u>Casetype</u>	<u>Case Disp</u>	14	0180S	0110E	<u>Sect</u>	<u>Sur Typ</u>	<u>Sur Num</u>	<u>Suff</u>	<u>Subdivision</u>	<u>Act Pend</u>
286007	AUTHORIZED				010	MNR		1	NWNWSW;	Y

Serial Number: AZA 029505

Total Case Acres: 1.000

<u>Casetype</u>	<u>Case Disp</u>	14	0180S	0110E	<u>Sect</u>	<u>Sur Typ</u>	<u>Sur Num</u>	<u>Suff</u>	<u>Subdivision</u>	<u>Act Pend</u>
286001	AUTHORIZED				010	MNR		1	NWNWSW;	

Serial Number: AZA 030600

Total Case Acres: 1.000

<u>Casetype</u>	<u>Case Disp</u>	14	0180S	0110E	<u>Sect</u>	<u>Sur Typ</u>	<u>Sur Num</u>	<u>Suff</u>	<u>Subdivision</u>	<u>Act Pend</u>
286001	AUTHORIZED				010	MNR		1	NWNWSW;	

Serial Number: AZA 034308

Total Case Acres: 0.320

<u>Casetype</u>	<u>Case Disp</u>	14	0180S	0110E	<u>Sect</u>	<u>Sur Typ</u>	<u>Sur Num</u>	<u>Suff</u>	<u>Subdivision</u>	<u>Act Pend</u>
286001	AUTHORIZED				010	ALIQ			NWSW;	

DEPARTMENT OF INTERIOR
BUREAU OF LAND MANAGEMENT

Input Parameters for Geographic Report with Land

System Id = CR

Admin State = AZ

Geo State = AZ

Casetype Begins With

Case Disp Txt = AUTHORIZED, CANCELLED, EXPIRED, PENDING, REJECTED, RELINQUISHED, WITHDRAWN

Mer Twp Rng =

Section =

Mtrs = 14 0180S 0110E 010, 14 0180S 0110E 999

Commodity =

Commodity Txt =

Pending Org =

Pend Org Decode =

Total Rows Returned: 6

RUN TIME: 09:23 AM

UNITED STATES DEPARTMENT OF THE INTERIOR
BUREAU OF LAND MANAGEMENT

RUN DATE: 06/29/2012

Input Parameters for CR Geographic Report with Customer

Total Rows Returned: 0

System Id = CR

Admin State = AZ

Geo State =

Casetype begins with 381401

Casetype Txt =

Case Disp Txt = AUTHORIZED, CANCELLED, CLOSED, EXPIRED, PENDING, REJECTED, RELINQUISHED, VOID, WITHDRAWN

Mer Twp Rng = 14 0180S 0110E

Section = 010, 999

Mtrs =

NO WARRANTY IS MADE BY BLM FOR USE OF THE DATA
FOR PURPOSES NOT INTENDED BY BLM

RUNTIME: 09:23 AM

UNITED STATES DEPARTMENT OF INTERIOR
BUREAU OF LAND MANAGEMENT
GEOGRAPHIC CROSS REFERENCE
Sorted by Meridian Township Range

RUNDATE: 06/29/2012
Page 1 of 1

NO WARRANTY IS MADE BY BLM FOR USE OF THE DATA
FOR PURPOSES NOT INTENDED BY BLM

RUNTIME: 09:23 AM

UNITED STATES DEPARTMENT OF INTERIOR
BUREAU OF LAND MANAGEMENT
GEOGRAPHIC CROSS REFERENCE
Sorted by Serial Number

RUNDATE: 06/29/2012
Page 1 of 1

NO WARRANTY IS MADE BY BLM FOR USE OF THE DATA
FOR PURPOSES NOT INTENDED BY BLM

TOWNSHIP 18 SOUTH RANGE 11 EAST OF THE GILA & SALT RIVER MERIDIAN, ARIZONA

SECS	SUBDIVISION																Acres	Kind of Entry or Purpose	Serial Number or Order Number	Action Date	Remarks		
	NE 1/4				NW 1/4				SW 1/4				SE 1/4									Lots	Other Description
	NE	NW	SW	SE	NE	NW	SW	SE	NE	NW	SW	SE	NE	NW	SW	SE							
For orders affecting disposal or use of unidentified lands withdrawn for classification, minerals, water, and/or other public purposes, and Indian treaties, refer to Index to Miscellaneous Documents																							
13					X																		
15	X	X	X	X									X	X	X	X	640.00	PATENT / SRHE	1092291	9/10/1937			
3			X			X	X	X	X				X				454.90	IL	156	11/12/1937	7S 21E;		
8																	40.00	IL	185	11/3/1938	28N 6W;		
20	X	X	X	X	X			X	X			X	X	X	X	X	480.00	PATENT / SRHE	1102578	5/8/1939			
5			X	X				X					X	X	X	X	467.56	IL	191	8/18/1939	11S 17E;		
																	DEFICIENCY;	4.80	IL BASE	200	6/11/1940	9S 30E;	
8			X	X									X	X	X	X	240.00	IL	214	3/3/1941	8N 6W;		
5								X			X						166.98						
6																	ALL;	548.42	PATENT / SX	1112867	1/19/1942	16S 32E;	
8	X																120.21	IL	215	9/22/1942	11S 29E;		
15					X	X	X	X	X	X	X	X					320.00	PATENT / SX	1115963	1/15/1943	17S 11E;		
7	X	X	X	X	X	X	X	X	X	X	X	X	X	X	X	X	600.00						
8					X	X	X	X									160.00	PATENT / SX	1125006	3/21/1949	OTHER TPS: 7S 14E, 15S 20E, 15S 21E, 15S 30E, 19S 24E, 19S 25E;		
3																	7-10						
4																X							
8		X																					
9										X	X						1-3						
10		X	X						X	X	X	X	X										
11	X	X	X	X					X	X	X	X	X	X	X	X							
12		X			X	X	X	X	X	X	X	X											
14	X	X	X	X	X	X	X	X	X	X			X	X				5S 2E;	O PROPOSED CL / FOR TRANSFER	A-2153	6/13/1968	PUB IN FR 6/20/1968; EXPIRED 6/20/1970;	
3																	7-10						
4																X							
9																	3						
10																	NWNWSW;	R/W COMMUNICATION SITE, ELECTRIC DISTRIBUTION LINE AND ACCESS ROAD	A-9630	5/5/1977	AMENDED 5/26/1977; RENEWED 7/6/1998;		
9																	1, 2	R/W ELECTRIC DISTRIBUTION LINE AMENDED	A-9630	5/26/1977	RENEWED 7/6/1998;		
10																	NWNWSW;	R/W COMMUNICATION SITE	A-9630-A	5/11/1978	TERM 5/5/1987; CASE CLOSED 7/9/1992;		

TOWNSHIP 18 SOUTH RANGE 11 EAST OF THE GILA & SALT RIVER MERIDIAN, ARIZONA

SECS	SUBDIVISION																Acres	Kind of Entry or Purpose	Serial Number or Order Number	Action Date	Remarks		
	NE 1/4				NW 1/4				SW 1/4				SE 1/4									Lots	Other Description
	NE	NW	SW	SE	NE	NW	SW	SE	NE	NW	SW	SE	NE	NW	SW	SE							
For orders affecting disposal or use of unidentified lands withdrawn for classification, minerals, water, and/or other public purposes, and Indian treaties, refer to Index to Miscellaneous Documents																							
34			X	X			X	X	X	X	X	X	X	X	X	X	480.00						
35												X					40.00	IL	69	3/14/1923	1S 8W;		
32							X										40.00	IL BASE	69	3/14/1923	1S 8W;		
30																	563.40	PATENT / SRHE	930937	1/31/1924	18S 10E;		
1																	636.72	PATENT / SRHE	942900	8/14/1924			
22																	640.00						
28																	640.00	SS PAYMENT OF BONDS	27	2/28/1925	OTHER TPS: 20S 11E, 20S 12E, 14N 2W;		
21					X	X	X	X									160.00	SS MILITARY INSTITUTE	12	3/16/1925			
32					X	X			X	X							160.00	IL	84	8/27/1925	11N 3E;		
																		STATE GRANT	ACT OF CONGRESS	1/25/1927	EXTENDS ACT OF 6/20/1910 TO MINERAL LANDS; SUBJECT TO PRIOR RIGHTS;		
12																	640.00	SRHE	PHX-066045	6/17/1929	REL 3/25/1931;		
10	X			X																			
11					X	X	X																
7															X		40.00						
18																	565.00	SRHE	PHX-072980	2/3/1933	REL 8/1/1933;		
7	X	X	X	X	X				X	X			X				1-4						
8					X	X	X	X									564.76	SRHE	PHX-073133	3/7/1933	CANC 12/11/1935;		
19																	564.20	IL	122	10/17/1934	18S 10E;		
17																	640.00	PATENT / SRHE	1073811	1/9/1935			
13	X	X			X												120.00	PATENT / SRHE	1077629	8/23/1935	18S 12W;		
4			X	X			X	X	X	X	X	X	X	X	X	X	581.33						
9		X	X		X	X	X	X	X			X		X	X		438.77	IL	154	8/14/1936	8S 20E;		
12	X		X	X								X	X	X	X	X	320.00	PATENT / SRHE	1088978	3/15/1937	18S 12E;		
13			X	X			X	X	X	X	X	X	X	X	X	X							
14											X	X			X	X	640.00	PATENT / SRHE	1088883	3/15/1937			
7															X								
8																	4						
18																	645.10	PATENT / SRHE	1090062	5/5/1937			
10					X	X	X	X						X	X	X							

PIMA COUNTY
TUCSON FIELD OFFICE

[illegible]

FOR ORDERS AFFECTING DISPOSAL OR USE OF
UNIDENTIFIED LANDS WITHDRAWN FOR CLASSIFICATION,
MINERALS, WATER AND/OR OTHER PUBLIC PURPOSES,
REFER TO INDEX OF MISCELLANEOUS DOCUMENTS.

MDS 602 NW

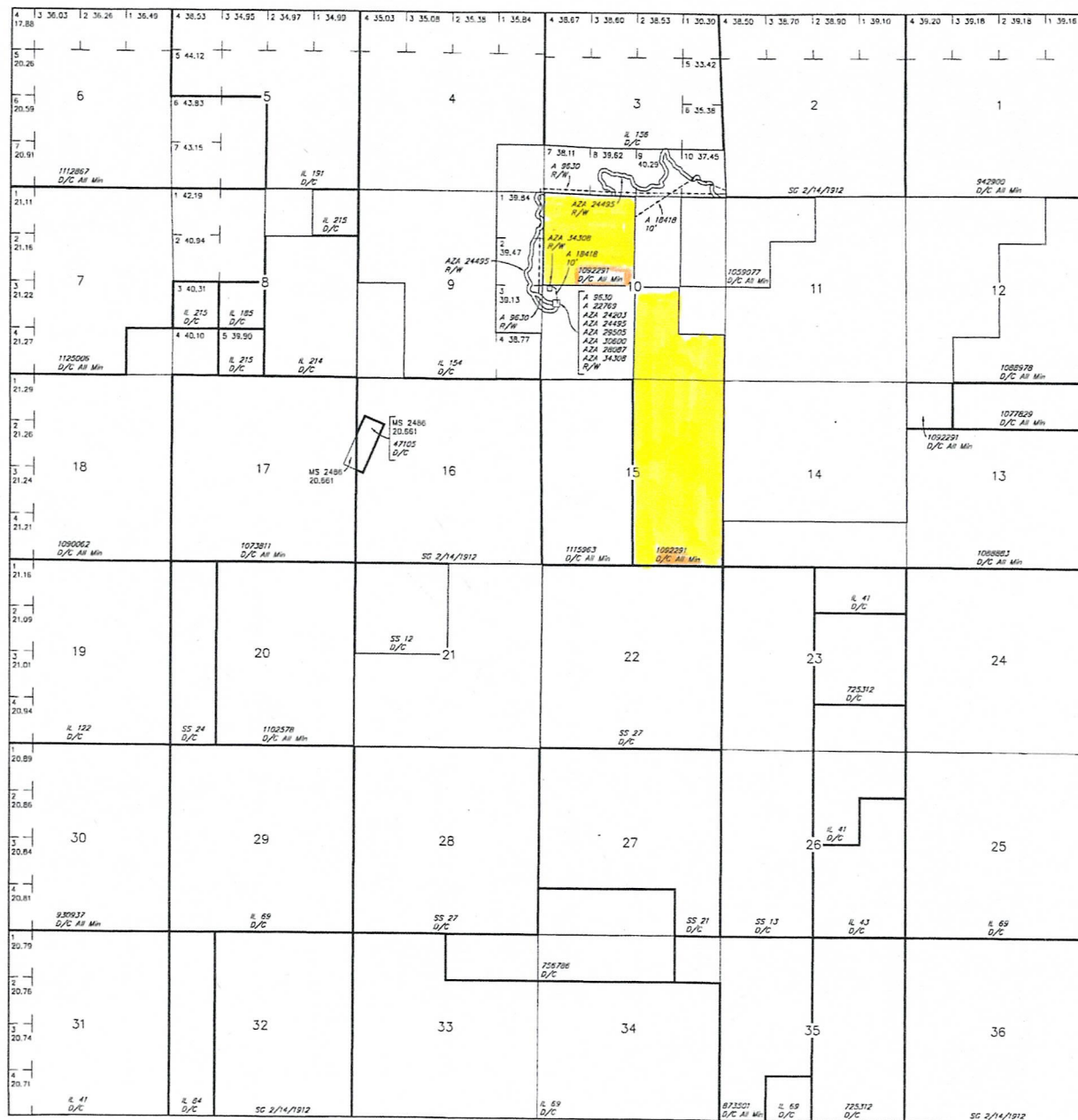

Lat	31°38'40"N
Long	111°09'33"W

SCALE in chains

WARNING STATEMENT
This plot is the Bureau's Record of Title, and should be used only as a graphic display of the township survey data. Records herein do not reflect title changes which may have been effected by lateral movements of rivers or other bodies of water. Refer to the cadastral surveys for official survey information.

CURRENT TO	NW	GSR Mer
1-10-2012	ACAD	T 18 S
		R 11 E

PIMA COUNTY
TUCSON FIELD OFFICE

[illegible]

MDS 602 NW

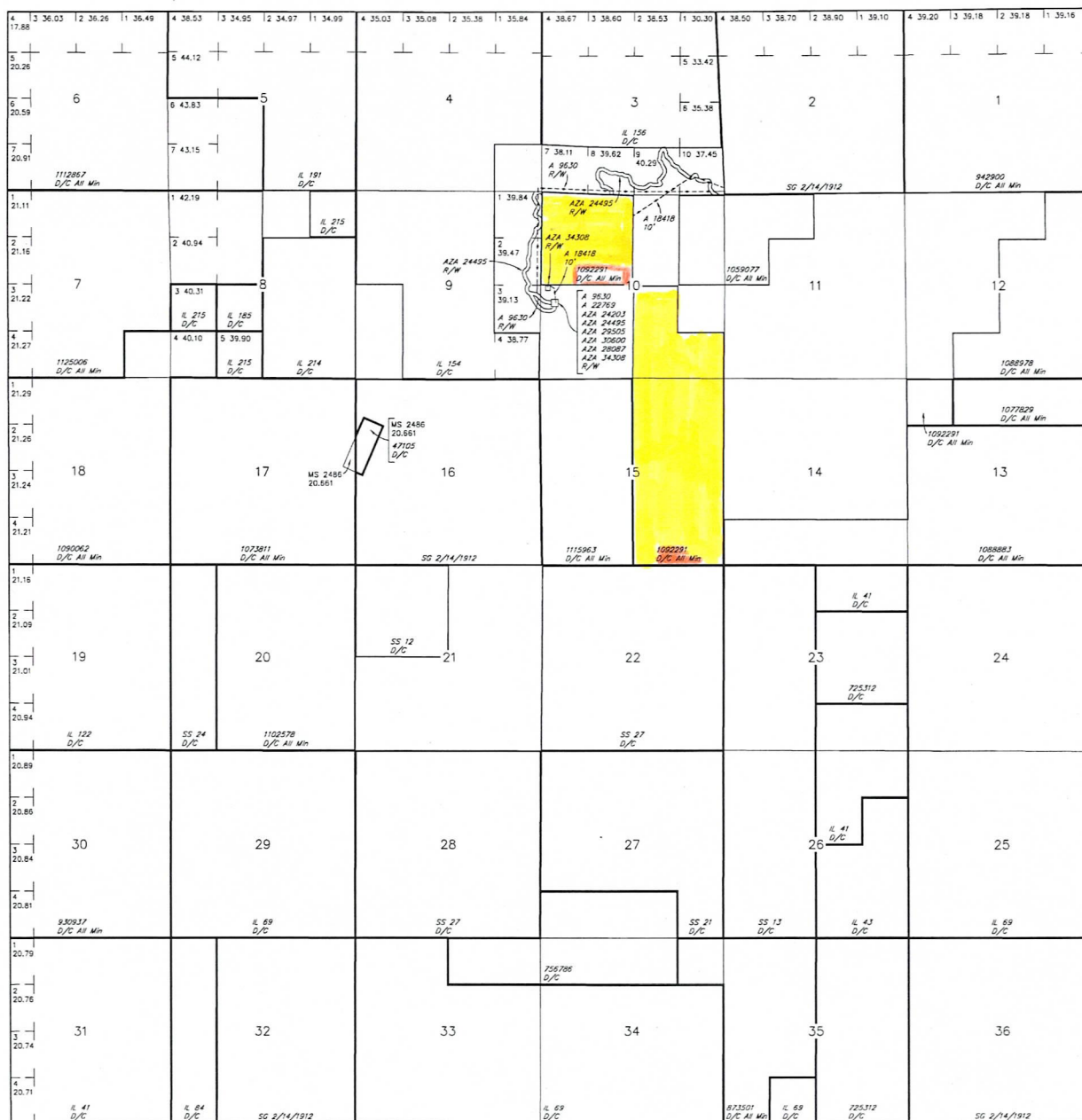

Lat 31°38'40"N
 Long 111°09'33"W

SCALE in chains

WARNING STATEMENT

WARNING STATEMENT

This plot is the Bureau's Record of Title, and should be used only as a graphic display of the township survey data. Records hereon do not reflect title changes which may have been effected by lateral movements of rivers or other bodies of water. Refer to the cadastral surveys for official survey information.

CURRENT TO	NW	GSR Mer
1-10-2012	ACAD	T 18 S
		R 11 E

	GSR	Mer
T	18	S
R	11	E